

The 20th Annual Congress for the New Urbanism Program Book



THE NEW WORLD

MAY 9 – 12, 2012
WEST PALM BEACH, FL

CNU 20

The Congress for the New Urbanism would like to acknowledge the following Partners for their generous support of CNU 20 and ongoing initiatives.

CHARTER AWARDS PARTNERS



SUSTAINABLE COMMUNITY PARTNERS:



GREEN NEIGHBORHOOD PARTNERS

AECOM
Abacoa Partnership for Community
Bon Secours Virginia Health System
Cardno
City of West Palm Beach
Cornish Associates
Florida Atlantic University
Gorman & Company
HDR
Mashpee Commons
National Association of REALTORS®
South Florida Regional
Transportation Authority
University of Miami School of
Architecture
West Palm Beach Downtown
Development Authority
Windsor

COMPLETE STREET PARTNERS

Brookwood Group with Laura Heery
Flagler
Florida Regional Councils Association
Fuss & O'Neill
Hall Planning & Engineering, Inc.
Mandel Group, Inc.
Ram Realty Services
Renaissance Downtowns LLC
Renaissance Planning Group
Robert A.M. Stern Architects LLP
Thomas Comitta Associates, Inc.
SmithGroupJJR

Union Studio Architecture & Community
Design
University of Notre Dame - School of
Architecture
Urban Design Kilday Studios
Urbsworks

TOUR PARTNERS

Butler Enterprises
Carlton Fields
MTP Group, Inc. - Traffic Engineers &
Transportation Planners

SCHOLARSHIP PARTNERS

Akerman and Senterfitt
Berger Singerman
Cotleur & Hearing
Gentile, Holloway, O'Mahoney
Gunster Yoakley
Palm Beach Kennel Club

A LA CARTE PARTNERS

1000 Friends of Florida
Chamber of Commerce of the
Palm Beaches
Florida APA
Huizenga Holdings
The Integral Group LLC
Kimley-Horn and Associates, Inc.
Law Offices of Roger G. Saberson PA
Lewis Stroud & Deutsch, PL

Robert S. Davis
University of Miami School of
Architecture New Urbanism Online
Waste Management

IN-KIND SUPPORTERS

Bacardi U.S.A., Inc.
Kolter
Palm Beach County Convention &
Visitors Bureau
REG Architects
Windsor

CNU 20 MEDIA PARTNERS

Architect's Newspaper
Better! Cities and Towns
Engaging Cities
Next American City
Sustainable Cities Collective
Urbanicity

SPONSOR A STUDENT DONORS

Monte Anderson
David Benjamin
CNU DC
Doris Goldstein
Chris Kozak
Frank Starkey
Ken Voigt
Roger Wood

SPECIAL EXHIBIT

WEDNESDAY MAY 9

CONGRESS REGISTRATION

7:00 AM - 7:00 PM

Convention Center Main Lobby

THE ART OF THE NEW URBANISM

Sponsored by the Chamber of Commerce of the Palm Beaches

Thursday, May 10, 3-8 pm

Friday, May 11, 4-6 pm and 7:30-9:30 pm

Saturday, May 11, 5-9 pm

West Palm Beach Lakefront Pavilion, 101 South Flagler Drive

The New Urbanist movement has dramatically transformed the way that illustrations and renderings are incorporated into the dialog of community planning and placemaking. New Urbanism has provided a means of visual communication that enables citizens from all walks of life to become engaged in planning their neighborhoods and communities. Beautiful artwork, vivid illustrations, compelling plans and communicative explanatory diagrams are all part of The Art of the New Urbanism. This important exhibit features some 200 visualization artworks produced by a broad range of new urbanist practitioners throughout the history of the movement.

BREAKFAST

8:00 AM-9:00 AM

Grand Ballroom Pre-function Area

GUIDED TOURS

All depart from and return to the convention center main entrance (Okeechobee Blvd). Require registration and a separate fee.

9:30 AM-11:30 AM / Palm Beach Urban Gardens

1:00 PM-5:00 PM / Abacoa

1:00 PM-5:00 PM / Delray Beach: "Style without Attitude"

NEW URBANISM 101

9:00 AM-12:00 PM / Ballroom C

This primer on the principles and concepts of New Urbanism will give Congress attendees the opportunity to learn how and why New Urbanism works. The half-day course provides an illustrated introduction and a foundation in key concepts such as conventional vs. traditional development; the Charter; why sustainability matters; and what makes a healthy community. Attend this session and you will walk away with an excellent understanding of the fundamentals of New Urbanism.

Philip Bess, Professor and Director of Graduate Studies, School of Architecture, University of Notre Dame; Andrés Duany, Principal, Duany Plater-Zyberk & Company

THE NEXT GENERATION OF NEW URBANISTS: A ONE-DAY CONGRESS

9:00 AM-5:00 PM / Ballroom B

Students, professionals, advocates, and new members will interact, debate, present ideas, and explore innovative ways to improve our built and natural environment. NextGen seeks to advance CNU through open source collaboration and encouraging participation among diverse experience levels, backgrounds, and fields. Help us build momentum and join the discussion. For additional program details and to connect digitally in advance of the session, visit www.cnunextgen.org.

Moderator: Will Dowdy, Associate, Anderson/Kim Architecture+Urban Design



NEW URBANISM 202s ADVANCED MORNING SESSIONS

The following sessions require registration and a separate fee.

202 A: CNU/ITE RECOMMENDED PRACTICE, DESIGNING WALKABLE URBAN THOROUGHFARES

9:00 AM-12:00 PM / Meeting Room 1 D

Healthy, vibrant and welcoming places require walkable streets—convenient thoroughfares to walk, bike, drive, use transit, and live our daily lives.

The Congress for the New Urbanism and the Institute of Transportation Engineers have developed a new resource, *Designing Walkable Urban Thoroughfares: A Context Sensitive Approach*, to help implement the essential requirements. The manual is a recommended practice for local communities to apply context-sensitive solutions to street design, and acts as a how-to document that illustrates best practices for the creation and implementation of walkable, mixed-use streets. This course will discuss the manual, and provide examples and best practices for its implementation in various locations and contexts.

Marcy McInelly, AIA, President, Urbsworks, Inc; DeWayne Carver, Senior Project Manager, Hall Planning & Engineering, Inc; Jim Daisa, Associate Principal / Transport Planning, ARUP

202 B: SMARTCODE CALIBRATION WORKSHOP

9:00 AM-1:00 PM / Meeting Room 1 B

This is a hands-on, feet-moving workshop. In just four hours we will complete what normally takes three days, or more - study base maps, complete field research, calibrate the open-source SmartCode model code metrics for a study area, sketch out a transect-based regulating plan, and compare the new T-zoning with the existing code. Three teams led by experienced code calibrators will hit the ground to calibrate (measure, photograph), so we end up with T3, T4, and T5 in our plan and code. The best way to learn SmartCode calibration is to just do it. Techniques learned here can be applied to any form-based code.

This 202 trains participants in the basics of customizing the model SmartCode for the local environment. This is a high-level workshop, and will assume the participant is familiar with the model SmartCode. Additional preparatory material will be provided in the month prior to CNU 20, including sample Synoptic Surveys, guides for calibration, and study area data.

Susan Henderson, AIA, LEED AP, CNU-A, Principal, PlaceMakers LLC; Jennifer Hurley, AICP, NJPP, CNU-A, President & CEO, Hurley-Franks & Associates; Matthew Lambert, Partner, Duany Plater-Zyberk & Company

202 C: SPRAWL RETROFIT: CORRIDORS AS THE THREAD THAT TIE EVERYTHING TOGETHER

9:00 AM-12:00 PM / Meeting Room 1 E

The first half will begin at the regional level and then drill down to a focus on corridor retrofit and repair strategies and briefly conclude the progression through to micro-scale repair. This 202 will chart the course from design to implementation and from tactical pre-vitalization techniques to innovative policy and funding successes. Building on this, the participants will then engage in a hands-on workshop addressing an existing corridor in the West Palm Beach area that is ripe for retrofitting. This same corridor will weave its way through many different pieces of CNU 20, including a walking tour and the second annual AuthentiCity competition (both included in the price of 202 participation). Those who participate in the SR202 will be provided with base information ahead of time, along with design criteria - armed with this and an expected 101 understanding of the concepts of Sprawl Retrofit, they will be asked to complete some initial work on the corridor which will provide the basis for the first half of the SR 202 - a design workshop, including critique by the field's leading minds.

Karja Hansen, Director's Fellow, Duany Plater-Zyberk & Company; Ellen Dunham-Jones, Professor of Architecture and Urban Design, Georgia Institute of Technology; Sarah A. Lewis, R.A., CNU-A, LEED AP, Associate/Project Director, Fuss & O'Neill; Lynn Richards, Policy Director, USEPA - Office of Sustainable Communities; Daniel K. Slone, Esquire, Partner, McGuireWoods LLP; Galina Tachieva, Partner, Duany Plater-Zyberk & Company

202 D: PLANNING & REDEVELOPMENT STRATEGIES FOR STREETS INTERSECTING MAIN STREET

9:00 AM-12:00 PM / Meeting Room 1 C

This 202 course will focus on the strategies used to foster redevelopment along secondary corridors that intersect with "Main Street." Using Delray Beach as the case study, a speaker panel, consisting of Delray Beach Community Redevelopment Agency staff and a developer, will discuss various urban design concepts, planning processes, and financial tools used to revitalize three streets that run perpendicular to the thriving Atlantic Avenue corridor in downtown Delray Beach. Despite the proximity of the three corridors to the economic anchors on Atlantic Avenue, their traffic patterns and surrounding neighborhoods required the CRA and the City of Delray Beach to adopt unique development strategies for each cross street. Workshop participants will learn how the opportunities were identified and how tailored strategies were developed and implemented. If interested, there is a separate Delray tour offered that will explore the Atlantic Avenue corridor.

Elizabeth Burrows, Marketing & Grants Manager, Delray Beach Community Redevelopment Agency; Diane Colonna, AICP, Executive Director, Delray Beach Community Redevelopment Agency; Jeffrey Costello, AICP, Assistant Director, Delray Beach Community Redevelopment Agency; Ana Puzskin-Chevlin, Senior Research Fellow, Florida Atlantic University

NEW URBANISM 202s ADVANCED AFTERNOON SESSIONS

The following sessions require registration and a separate fee.

2:00 PM-5:00 PM

202 E: PRINCIPLES OF URBAN RETAIL PLANNING & DEVELOPMENT

Meeting Room 1 F

West Palm Beach is an ideal example of retail success with its thriving downtown corridor and lifestyle center. This fast-paced course will discuss how proven principles of modern retail development were combined with the best practices of New Urbanism to create sustainable mixed-use urban commercial centers in downtown West Palm Beach at both Clematis Street and CityPlace. The session will focus on the required market demographics for leading regional and national retailers and restaurants, new national retailer trends, essential site design and programming factors. The session will also emphasize the differences in development between Clematis Street (downtown corridor) and CityPlace (lifestyle center) as well as review lessons learned from Naples, Charleston and Miami Beach. Gibbs will also discuss his new book, *Principles for Urban Retail Planning & Development*.

Marcela Cambor, AICP, Principal, Marcela Cambor & Associates; Michael Dunning, Principal, Shook Kelley, AIA, CNU, LEED AP; Robert Gibbs, President, Gibbs Planning Group; Dana Little, AICP, Urban Design Director, Treasure Coast Regional Planning Council

202 F: TRAFFIC SAFETY AND URBAN DESIGN

Meeting Room 1 D

This course will orient New Urbanists to the issues and choices in modern urban traffic safety. Over the past 50 years, street design in the U.S. has been guided by rural design principles with an emphasis on reducing fatalities in high speed settings — principles that have little applicability in cities and towns. Much of the information provided to the public about urban streets and public safety is inaccurate and leads to confusion and misunderstanding about the relationships between street design, urban form and travel safety. For example, many “congestion relief” projects have the effect of increasing crash rates and accident severity. Traffic Safety 202 is intended to provide planners, urban designers and local leaders with facts about safety trends for motor vehicles, bicyclists and pedestrians, as well as information about how the design of city streets affects crash rates and how functional streets and walkable places can coexist. The course will provide practical tools for use by New Urbanists in redirecting local decision-making about street design to reduce crash rates while meeting objectives for access and circulation.

Eric Dumbaugh, Associate Professor and Graduate Coordinator, School of Urban and Regional Planning, Florida Atlantic University; Norman W. Garrick, Associate Professor, Civil and Environmental Engineering, University of Connecticut

202 H: SMART GROWTH A TO Z

Meeting Room 1 E

Where does New Urbanism end and Smart Growth begin? (Hint: that’s a trick question.) In an effort to fully inform the Smart Growth discussion with the design focus and real-world smarts of the New Urbanism, Andrés Duany, Jeff Speck, and Mike Lydon recently published the *Smart Growth Manual*. This valuable resource gives planners, developers, and municipalities a central tool both for creating Smart Growth and for assessing proposals that claim to satisfy its criteria. Using the Manual as a jumping-off point, the authors will delve deeply into the most interesting and challenging issues at the nexus of two important parallel movements.

Andrés Duany, Principal, Duany Plater-Zyberk & Company; Mike Lydon, Principal, The Street Plans Collaborative; Stewart Schwartz, Executive Director, Coalition for Smarter Growth; Jeff B. Speck, CNU-A, AICP, LEED AP, Honorary ASLA, Principal, Speck & Associates LLC

202 I: THE CRITICALITY OF QUALITY ARCHITECTURE - ADDING VALUE IN A DOWN MARKET

Meeting Room 1 C

A group of successful New Urbanist real estate developers and town architects will show the value added through thoughtful guidance and implementation of architecture pattern books and guidelines. They will use specific examples, both visual and numerical, to show how they are maintaining, even increasing land and home values for some of the most successful projects in the New Urbanist world and in the regions where they are building. In their presentations and group discussion, the presenters will discuss specific methodologies for, and results of, implementing a strong design management program for New Urbanist neighborhoods. The panel will invite audience participation in the last hour of the program.

Moderator: Elizabeth Plater-Zyberk, Principal, Duany Plater-Zyberk & Company; Timothy Busse, Vice President (Director of Architecture), New Town St. Charles; Jane Grabowski-Miller, ASLA, CNU-A, Vice President Design Development, Erdman Development Group; Steve A. Mouzon, AIA, LEED, Principal, The New Urban Guild; Giovanni Palladino, Vice President Design Development, Leyland Alliance LLC; Michael Watkins, AIA, AICP, NCARB, LEED AP, CNU-A, Architect, Michael Watkins Architect, LLC; Roger Wood, AIA, Town Architect & Guild Manager, East Beach Company, LLC

EXHIBITS

5:00 PM-8:00 PM

Grand Ballroom Pre-function Area

OPENING PLENARY. TWENTY YEARS OF THE CNU: LOOKING BACK, LOOKING FORWARD

5:30 PM-6:30 PM

Grand Ballroom

CNU founder Elizabeth Plater-Zyberk opens CNU 20 with perspectives on where we were two decades ago, the achievements of the CNU over the past twenty years, and new challenges facing proponents of urbanism today. The CNU story encompasses a multitude of individuals and groups who came together in support of a larger, shared vision of livable community design. It is a human story of people acting individually and collectively to identify and apply New Urbanist principles and goals. The opening plenary will also include an introduction by CNU founder Stefanos Polyzoides and the presentation of CNU-Florida’s Nolen Award.

Charles C. Bohl, Professor and Director, MRED+U Pgm, School of Architecture, University of Miami; John O. Norquist, President and CEO, Congress for the New Urbanism; Elizabeth Plater-Zyberk, Principal, Duany Plater-Zyberk & Company; Stefanos Polyzoides, Principal, Moule & Polyzoides Architects & Urbanists

EXHIBITS RECEPTION

6:30 PM-8:00 PM

Grand Ballroom Pre-function Area



THURSDAY MAY 10

CONGRESS REGISTRATION

7:00 AM - 7:00 PM

Convention Center Main Lobby

ORIENTATION BREAKFAST FOR FIRST-TIME ATTENDEES

8:00 AM-8:30 AM

Meeting Room 2 DEF

First-time attendees are invited to participate in this informational orientation breakfast. Leaders of the Congress for the New Urbanism will guide you through Congress events and sessions.

Stephanie Bothwell, ASLA, Principal, Urban & Landscape Design

BREAKFAST

8:00 AM-9:00 AM

Grand Ballroom Pre-function Area

EXHIBITS

8:00 AM-3:45 PM

Grand Ballroom Pre-function Area

GUIDED TOURS

All depart from and return to the convention center main entrance (Okeechobee Blvd). Require registration and a separate fee.

12:00 PM-1:30 PM / Clematis Street Walking Tour (Thursday)

1:00 PM-3:00 PM / Historic Palm Beach Walking Tour

3:30 PM-5:00 PM / CityPlace: 12 Years After

Sponsored by Carlton Fields

MEET THE CANDIDATES: CNU BOARD ELECTIONS

8:30 AM-9:00 AM

Grand Ballroom

Let your voice be heard and have a say in who leads CNU. Join CNU Board Chair Victor Dover and CNU President John Norquist for a brief introduction to the new Board election process, meet the 2012 candidates and cast your vote for CNU's first ever member election to the Board.

Moderator: Victor Dover, CNU-A, Principal, Dover, Kohl & Partners

John O. Norquist, President and CEO, Congress for the New Urbanism

LOOKING FORWARD: NEW URBANISM AND THE NEW WORLD

9:00 AM-12:00 PM

Grand Ballroom

As we enter CNU's third decade, economic, political, and environmental conditions pose serious challenges for the built and natural environment, as well as New Urbanist practice. Two of CNU's founders will open this session with lectures addressing these challenges. Andrés Duany will present the 21st century crises that call for New Urbanists to adapt, including slow development, the public process, suburban retrofit, agricultural urbanism, and the theology of metrics. Dan Solomon will discuss the tensions between New Urbanism's roots in the nuanced complexity of the city and the reductive codifying of New Urbanist practice. Following the opening lectures, we will tackle New Urbanism's future with open source small group discussions around the theme of "How can the New Urbanism help us meet the challenges of the New World?" These sessions will launch this year's Open Source Congress.

Moderator: Jennifer Hurley, AICP, NJPP, CNU-A, President & CEO, Hurley-Franks & Associates

Andrés Duany, Principal, Duany Plater-Zyberk & Company; Daniel Solomon, Principal, Daniel Solomon Design Partners

2012 CHARTER AWARDS

Sponsored by CNU Florida

Support from The Oram Foundation/Fund for the Environment and Urban Life

12:15 PM-1:45 PM

The Harriet Himmel Theater, 700 S. Rosemary Avenue #200, West Palm Beach. Bring your own lunch. Boxed lunch available for purchase in the Grand Ballroom pre-function area of the convention center.

Doug Kelbaugh, CNU Board member, Professor of Architecture and Urban Planning, and former dean of the Taubman College of the University of Michigan, will honor the best of New Urbanism in the 2012 Charter Awards ceremony. Winning projects are recognized for their excellence in fulfilling and advancing the principles of the Charter of the New Urbanism, which defines the essential qualities of walkable, sustainable places from the scale of the region down to the block and building.

As jury chair, Kelbaugh will describe the lessons and trends learned from this year's award winners and frame how New Urbanism is reshaping and redeeming our cities and towns. For more information about the 2012 Charter Awards, visit www.cnu.org/awards.

This year, the Charter Awards will offer a prize of \$3,500 to the best professional project and \$3,500 for the best academic project, courtesy of The Oram Foundation/Fund for the Environment & Urban Life.

AFTERNOON BREAKOUT SESSIONS

2:00 PM-3:15 PM

SPACE, THE FIRST BUT NOT FINAL FRONTIER: ANALYZING SPACE, USES, AND TRANSPORTATION

Meeting Room 2 DEF

Showcasing research on the relationship between urban form and New Urbanism, a number of papers were selected for their academic rigor, originality, scholarship, and creativity. If you are interested in the most recent urban form investigations and trends, you won't want to miss this session.

Moderator: Elizabeth Plater-Zyberk, Principal, Duany Plater-Zyberk & Company
M. Gordon Brown, Principal, Space Analytics, llc; Paul L. Knight, Intern Architect and Urban Designer, Historical Concepts; Valentin Hadelich, Assistant Professor, Bauhaus University Weimar; Wesley Marshall, Ph.D., P.E., Assistant Professor, Department of Civil Engineering, College of Engineering and Applied Science, University of Colorado, Denver

CNU 20 ART ROOM: PHOTOGRAPHING THE BUILDING, STREET, AND TOWN

Meeting Room 1 L

Learn critical fundamentals to keep in mind when photographing urbanism. You'll also learn to use simple digital image editing tools to adjust and correct problematic photos and improve your visual communication.
Sandy Sorlien, Transect Codes Council

THE SECRET LIFE OF TREES

[Architecture and Placemaking]

Grand Ballroom

Trees are an important element in making successful public realms. There are physical, chemical, psychological, visual and health benefits to planting trees in areas of human habitation. Yet, decisions made by architects, planners and urban designers prevent the healthy growth of vegetation. This session will examine techniques, physical limitations, and maintenance strategies for incorporating trees in new and existing developments.

*Moderator: Mary Dennis, B. Dennis Town & Building
Keith Bowers, FASLA, RLA, PWS, President, Biohabitats Inc.; Dennis McGlade, Principal, Olin Partnership*

THE REAL DEAL: IMPLEMENTED INCREMENTAL URBANISM

[Incremental Entrepreneurial City]

Ballroom A

With today's radically different development economics comes renewed interest in smaller projects which, in some markets, are becoming the norm. Financial constraints, combined with the desire to leverage existing infrastructure for optimal sustainability, are making urban infill projects the most sensible direction for growth. This session will present a variety of recently-constructed projects - residential, mixed-use, and adaptive re-use - from around the country. Developers and designers will present lessons learned, including how challenges of financing, zoning and permitting were overcome.

Sarah A. Lewis, R.A., CNU-A, LEED AP, Associate/Project Director, Fuss

& O'Neill; Donald Powers, AIA, LEED AP, Founding Partner, Union Studio, Architecture & Community Design; Linda Pruitt, President, The Cottage Company; Robert Sharp, Principal, Robert Sharp Architect, Inc., Partners for Better Housing

WHERE IS THE MARKET TAKING US?

[Looking Back, Looking Forward]

Ballroom B

A series of demographic and economic forces are coming together to radically change the housing market in the coming decade. Find out how this will shape urbanism in North America today and in the future. Experts on the market tell us how changing demographics and consumer preference will shape how New Urbanism is planned and built in the next decade.

*Moderator: Laurie Volk, Co-Managing Director, Zimmerman/Volk Associates
Lawrence Frank, Ph.D., AICP, CIP, ASLA, President, Urban Design 4 Health
Shyam Kannan, Principal, RCLCO; Kennedy Smith, Principal, Community Land Use and Economics Group*

PARKING: PLANNING TO STORE THE CARS PROPERLY, AMID THE PEDESTRIANS! [Mobility and the Walkable City]

Meeting Room 2 DEF

Parking is a vital design component of New Urbanism, but requires comprehensive thought for planning and subsequent operations. Suburban sprawl's parking policies thwart compact urban placemaking. Too much parking and the scale of a development is blown out; too little and places starve for lack of financing and approvals. How do we strike a balance? How can a designer know if it is more cost effective to make better use of existing parking than build new? Answer these and other questions in this session that will feature case studies of Seaside, FL and Savannah, GA, and have a Q&A between the audience and presenters.

Tracy Hegler, AICP, Planning Director, Richland County Planning & Development Services; Jeff Tumlin, Principal, Nelson\Nygaard Consulting Associates

Save on these and other Wiley titles at the CNU Bookstore!

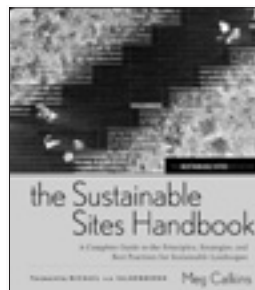
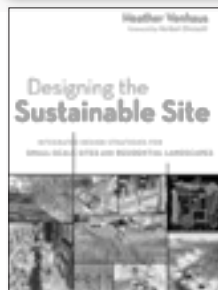
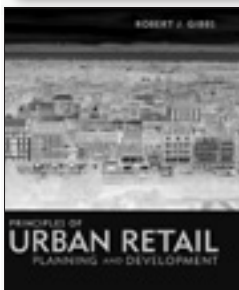
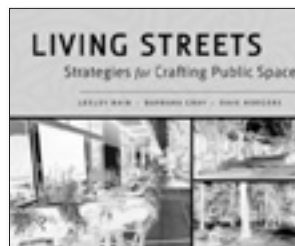
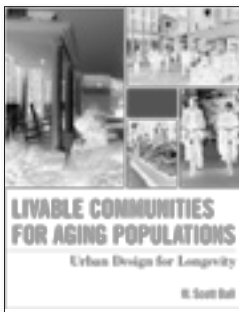

See reverse side for details.

 **WILEY**
Now you know.
wiley.com

TOO MUCH WATER OR TOO LITTLE? USING THE LANDSCAPE TO ADVANCE REGIONAL SUSTAINABILITY WITHOUT DESTROYING URBANISM: A FLORIDA TRANSECT

[Sustainability and Livability]

Meeting Room 2 ABC

This session will discuss the practical use of landscape techniques to advance regional sustainability in Florida and whether these techniques can be utilized without undermining urbanism. We will also discuss the landscape consequences of reasonably anticipated sea-level rise. Will the Keys disappear by 2015 or will salt-water intrusion transform the coastal life? For purposes of this session, "landscape" is broadly used to include the site, storm-water management, urban agriculture, green roofs and walls, streams, right-of-ways, parks and green infrastructure.

Moderator: Stephanie Bothwell, ASLA, Principal, Urban & Landscape Design Jonathan Barnett, Professor of City and Regional Planning, University of Pennsylvania; Marcela Cambor, Principal, Cambor and Associates; Daniel K. Slone, Esquire, Partner, McGuireWoods LLP; Lee Sobel, Real Estate Development and Finance Analyst, U.S. Environmental Protection Agency: Office of Policy, Economics and Innovation

EXTENDED BREAKOUT SESSIONS

2:00 PM-5:00 PM

202 J: HOW TO LEASE A TOWN CENTER WITH PROVEN RESULTS- THE RESTAURANT EFFECT

Meeting Room 1 HI

Requires registration and a separate fee

What brings energy, personality and vibrancy to cities, towns and mixed-use development projects? At the core of any great place are the restaurants, bars, cafes and entertainment concepts that help to shape the personality of the place they are a part of. Restaurants are often catalysts in the birth

or re-birth of 'great places'. In almost every case of great precedents of neighborhoods in transition, the initial sparks were the business pioneers who opened destination restaurant experiences that "got people talking." By understanding the fundamentals of what makes restaurants successful both individually and as part of a comprehensive food and entertainment strategy, you will be better equipped to implement a highly specialized approach to deal-making and securing world-class eateries for a New Urbanist Town Center.

In this educational, interactive and fun session, we will explore restaurants and the unique deal-making approach on how to source and secure the "best of the best," driving lease momentum and "place" for your Town Center. Our panel of experts will include professional restaurateurs, developers, and restaurant deal-making specialists with experience in the leasing, development and operation of these successful projects.

Ryan Bloom, Vice President, Implementation & Activation, LiveWorkLearnPlay; Ron Green, Founder & CEO, Another Broken Egg Cafe; Richard Martz, Vice President, Commercial Planning & Solutions, LiveWorkLearnPlay; Rob Spanier, Vice President, LiveWorkLearnPlay

OPEN SOURCE CONGRESS

Meeting Room 1K

The Open Source Congress is the DIY forum that arises annually during the Congress for the New Urbanism. You can use the time and space to talk about new ideas, find help on a thorny problem, or work on a CNU initiative. Check the schedule on the Open Source news board or follow updates on Twitter at #cnuopen. Then join a session or create one of your own and let the collaboration begin.

BREAK

3:15 PM-3:45 PM

Grand Ballroom Pre-function Area



\$5 OFF any Wiley title purchased at the CNU Bookstore!

Limit one coupon per title. Not valid online. Valid May 9-12, 2012. Coupon must be presented and surrendered at the time of purchase. Not valid on previous purchases or in conjunction with any other offers or coupons. Sales tax, shipping and handling are not included in total purchase calculation.

Subscribe to our free Architecture and Design eNewsletter to receive promotions on new titles!

E-mail _____

LATE AFTERNOON BREAKOUT SESSIONS

3:45 PM-5:00 PM

CNU 20 ART ROOM: RENDERING IN PEN AND INK

Meeting Room 1 L

Effective line drawing is fundamental to the delineation of architecture and urbanism. You'll learn a classic, easy-to-follow line drawing process combining the study of architectural proportions with time-tested pen and ink drawing techniques.

Eric Osth, Principal, Urban Design Associates

HETERODOXIA ARCHITECTONICA

Room 2 ABC

Heterodoxia Architectonica proposes a theory for architecture. Like urbanism, which depends on an underlying theory such as zoning or the transect, it is not enough that architecture be "authentic" or "green" or "urban." These mean a great deal, but they do not help with the aesthetic element. The proposed theory is one that bridges classicism and modernism, emphasizing that architecture must communicate with regular folk. This session will be an early presentation of the theory.

Andrés Duany, Principal, Duany Plater-Zyberk & Company

PRO FORMAS FOR THE REST OF US

[Incremental Entrepreneurial City]

Meeting Room 2 DEF

The ways people make money and lose money with building projects are not mysterious, but the methods used by developers to assess and manage risk can be opaque to those who don't use them every day. The presenters will teach you how to use the basic tool for understanding a project's feasibility and profitability, the pro forma.

What does it mean when a developer says they "can't make the numbers work"? Which numbers? How do these numbers work over time? If the pro forma is based upon assumptions, how can I test those assumptions in the real world? How important is the price of land or the allowed density within the overall project?

This session includes an exercise in which participants will use a static pro forma to an infill rental housing project and test a range of real world problems, delayed entitlements, construction cost overruns, and changes in financing. Spreadsheet files of model static and multiyear pro formas will be provided.

Moderator: R. John Anderson, Principal, Anderson Kim

Architecture + Urban Design

Frank Starkey, President, Longleaf Development Co.; Richard Hunt,

Principal, Peloton Research Partners

WHY WE WRITE: PROMINENT NEW URBANIST AUTHORS DISCUSS THEIR CLASSIC NU BOOKS AND CURRENT WORKS, AND THE CRITICAL IMPORTANCE OF WRITING TO THE MOVEMENT [Looking Back, Looking Forward]

Grand Ballroom

Join this moderated discussion with the authors of path-breaking, "core" new urbanist books and new media. Listen to the reconsideration of cornerstone texts that were influential in shaping the movement and how they relate to the authors' current ideas. Discussion of the critical importance of writing to the movement and gaps in the literature on the theory, practice and relevance of the New Urbanism to contemporary challenges will be addressed. The authors will share their ideas on writing influential texts and blogs on walkable, mixed-use communities.

Moderator: Charles C. Bohl, Professor and Director, MRED+U Program, School of Architecture, University of Miami

Philip Langdon, Senior Editor, Better! Cities & Towns; Peter Katz, Consultant and author of The New Urbanism: Toward an Architecture of Community, James Howard Kunstler, Author; Charles Marohn, Jr., P.E., AICP, Executive Director, Strong Towns

WHY DID WE STOP WALKING & HOW DO WE START AGAIN? THE DAWN OF THE MOTOR AGE IN THE AMERICAN CITY

[Mobility and the Walkable City]

Ballroom C

Before the advent of the automobile, users of city streets were diverse and included children at play and pedestrians at large. By 1930, most streets were primarily motor thoroughfares where children did not belong and where pedestrians were condemned as "jaywalkers." In *Fighting Traffic*, Peter Norton argues that to accommodate automobiles, the American city required not only a physical change, but also a social one: before the city could be reconstructed for the sake of motorists, its streets had to be socially reconstructed, creating a vision of places where motorists belonged. It was not an evolution, he writes, but a bloody and sometimes violent revolution. Street users struggled to define and redefine what streets were for. This session will offer a clear understanding of the critical evolution of automobility in urban environments. Discussion will inform new urbanists of this history.

Moderator: Richard Hall, P.E., President, Hall Planning & Engineering Inc. Eric Dumbaugh, Associate Professor and Graduate Coordinator, School of Urban and Regional Planning, Florida Atlantic University; Peter Norton, Assistant Professor, Department of Science, Technology, and Society at the University of Virginia

TWO TRADITIONS OF LATIN AMERICAN URBANISM

[New Urbanism in the New World]

Ballroom B

The Law of the Indies resulted in the wonderful gridded places that we admire, like Antigua, Guatemala and Villa de Leyva, Colombia. The Portuguese brought over their own nameless, organic method which was highly topo-responsive and unlike the Law of the Indies, did not shy away from sloping sites for places to inaugurate cities. This resulted in the highly irregular plans of many Brazilian towns and cities like Salvador, Ouro Preto, Goiás, Mariana, Tiradentes, Diamantina, and São Francisco do Sul. This session will compare and contrast the urbanism of these two different spheres and explore two colonial Brazilian examples that are directly influenced by the Hispanic Laws of the Indies.

Moderator: Andrew Georgiadis, Dover Kohl & Partners

Eduardo Castillo, Principal, Castillo Arquitectos, Guatemala; Maria Elisa Mercer, Project Manager/Business Development in South America, Duany Plater-Zyberk & Company

MAKING URBAN FACADES

[Architecture and Placemaking]

Ballroom A

Athena Award Winner Michael Dennis will share his insights on urban design principles and making urban facades. Urban facades are critical in the making of unified and composite streets. The session will survey the typology of urban facades from the Renaissance to present day. Facades will be categorized by compositional strategies: centralized, lateral, self-referential, symmetrical, and asymmetrical. The analysis and taxonomy survey will conclude with a review of design guideline strategies for making apt urban facades.

Introducer: Dhiru Thadani, AIA, Architect + Urbanist

Michael Dennis, Principal-in-Charge, Michael Dennis and Associates (MDA)

ATHENA MEDAL AWARDS PLENARY: THE UNIQUENESS OF URBAN DESIGN

5:30 PM-6:30 PM / *The Harriet Himmel Theater, 700 S. Rosemary Avenue #200, West Palm Beach*

Our understanding of Urban Design has emerged from the unique conditions and requirements of the dense traditional city, where we have focused our practice for the past 40 years. Primary among these is the need to combine high-rise towers with mid- or low-rise, high-density fabric to satisfy the economic requirements of the contemporary city.

The demographic trend away from the center city to the suburb in the U.S. has been reversed over the last generation -- our cities are growing again. We are further witnessing intense urbanization from a population explosion in the developing world. As a result, differences and similarities between urban design and town planning need to be identified to adequately address issues of the increasing scale, size and density we are experiencing.

These include how to tolerate multiple stylistic architectures in a coherent manner; how to design urban continuity with non-uniform and frequently changing architectural components; and how to make an architecture with contextual connections that provide surface continuities with its neighbors. In the city, individual buildings must touch and blend to form a solid block perimeter containing inner privacy and an outer edge of public space.

*Introducer: Dhiru Thadani, AIA, Architect + Urbanist
Michael Dennis, Principal-in-Charge, Michael Dennis and Associates (MDA)
Barbara Littenberg, Peterson Littenberg Architecture & Urban Design
Steven Peterson, Peterson Littenberg Architecture & Urban Design*

CHAPTER MEET-UPS

7:30 PM – 9:30 PM

Chapter Meet-Ups are evening receptions where you can gather with other new urbanists from back home to network and learn about what's happening in your region. For more information about CNU chapters, visit www.cnu.org/chapters.

CNU ATLANTA CHAPTER MEET-UP

E.R. Bradley's, 104 S. Clematis Street

Come meet up with your fellow Georgia new urbanists for an informal happy hour. Hear about local CNU Atlanta initiatives, upcoming chapter events, share your experiences at the conference or talk about the latest goings on in Georgia. No RSVP is required and the cost of attending is what you're willing to pay for a drink.

CNU CASCADIA CHAPTER MEET-UP

World of Beer, 101 N Clematis Street, Suite 100

Join CNU Cascadia (Washington, Oregon, British Columbia) at World of Beer. Learn more about coming events and how you can get involved. Join the dialogue about creating enduring, resilient cities. No RSVP required; look for CNU Cascadia signs.

CNU DC AND NEW ENGLAND CHAPTERS MEET-UP

Grease Burger Bar, 213 Clematis Street

Please join D.C. and New England members for a burger and a brew before visiting other CNU chapter friends along Clematis.

CNU FLORIDA AND NEW YORK CHAPTERS MEET-UP

Sky 309, 309 Clematis Street

CNU Florida and CNU New York urbanists will meet "Up on the Roof" at Sky 309, over Roxy's Pub. Please join us for great urbanist exchanges, help celebrate CNU 20 and look ahead to CNU 21-Salt Lake and CNU 22-Buffalo as we enjoy a 360-degree view of West Palm's urban core.

CNU GREAT LAKES CHAPTERS MEET-UP

Roxy's Pub, 309 Clematis Street

Meet and greet fellow CNU members from the Great Lakes Region including Illinois, Michigan, Wisconsin and Minnesota. Learn first hand about regional events or talk about the latest in the Midwest.

CNU NORTHERN CALIFORNIA CHAPTER MEET-UP

Pistache Restaurant, 101 N. Clematis Street, Suite 100

All Californians are invited to the Northern California Chapter Meet-Up. First, meet your peers from all over the Golden State, and then conspire to activate our Chapter event program.

CNU TEXAS: NORTH, CENTRAL AND HOUSTON CHAPTERS MEET-UP

O'Shea's Irish Pub, 531 Clematis Street

The three CNU chapters from Texas invite urbanites to convene at our Lone Start Meet Up at O'Shea's Irish Pub. Come share a libation or three with your fellow Texans and share your ideas of a grand urban future in the Great State.



FRIDAY MAY 11

CONGRESS REGISTRATION

7:00 AM - 7:00 PM

Convention Center Main Lobby

BREAKFAST

8:00 AM-9:00 AM

Grand Ballroom Pre-function Area

EXHIBITS

8:00 AM-5:30 PM

Grand Ballroom Pre-function Area

GUIDED TOURS

All depart from and return to the convention center main entrance (Okeechobee Blvd). Require registration and a separate fee.

10:30 AM-1:30 PM / CityPlace/Clematis Street Walking Tour

Sponsored by MTP Group, Inc. - Traffic Engineers & Transportation Planners.

2:00 PM-4:00 PM / Bike Tour of Palm Beach

2:00 PM-5:00 PM / Historic Neighborhoods and Bed & Breakfasts Tour

9:30 PM-11:30 PM / Worth Avenue: After-Hours Street-Level

Merchandising Tour

Sponsored by Butler Enterprises

FRIDAY MORNING GATHERING AND PHOTO

9:00 AM-10:15 AM

Grand Ballroom

Mathew McElroy, El Paso, TX City Planner, is this year's recipient of the Groves Award. This recognition is named after Ken Groves - the visionary planner who began the transformation of Montgomery, AL from hollowed-out sprawl victim to revived, historic city. The Groves Award is awarded annually to honor the designer or local leader whose achievements best fulfill the vision and promise Groves left behind. This year, CNU recognizes McElroy's accomplishments in strengthening the urban fabric of El Paso.

Join us as leaders of CNU 21 describe the fabulous setting of Salt Lake City, including how the Envision Utah Plan organized by CNU Co-founder Peter Calthorpe and new light rail transit lines are making Salt Lake City one of America's fastest-improving cities.

Moderator: Victor Dover, CNU-A, Principal, Dover, Kohl & Partners Mathew McElroy, AICP, CNU-A, Deputy Director, Planning & Economic Development, City of El Paso, TX; John O. Norquist, President and CEO, Congress for the New Urbanism

CNU 20 Group Photo: The New Urbanists 2012

Immediately following the Friday Morning Gathering, please listen for instructions for a mass photograph to commemorate CNU's 20th Congress. Award winning new urbanist photographer Art Cueto will be ready to snap the picture at 10:10am sharp. Don't miss it!

BREAK

10:15 AM-10:45 AM

Grand Ballroom Pre-function Area

MORNING BREAKOUT SESSIONS

10:45 AM-12:00 PM

CNU 20 ART ROOM: SKETCHUP AS A FOUNDATION FOR QUICK CHARRETTE HAND DRAWING

Meeting Room 1 L

Are you interested in learning how to produce quick charrette renderings? First, you'll learn how to build a quick 3D model in SketchUp to use as a drawing base - then we'll concentrate on accelerated charrette hand drawing overlay techniques.

Kenneth Garcia, Town Planner, Dover, Kohl & Partners; Eduardo Castillo, Principal, Castillo Arquitectos, Guatemala

PHILANTHROPY AND THE NEW URBANISM

Ballroom A

Philanthropy and the New Urbanism features top philanthropic leaders sharing their views of urbanism as a key factor in transformational change. The eponymous founders of The Richard H. Driehaus Foundation and The Oram Foundation/Fund for the Environment & Urban Life join Jerry Maldonado of the Ford Foundation to discuss how they make decisions that help their foundations meet their goals.

Moderator: Rob Steuteville, Editor/Publisher, Better! Cities & Towns Richard H. Driehaus, Chairman, Driehaus Capital Management LLC, President, The Richard H. Driehaus Foundation; Jerry Maldonado, Program Officer, Ford Foundation; Richard L. Oram, Chairman, Oram Foundation, Inc./ Fund for the Environment & Urban Life

THE ECONOMIC BENEFIT OF GOOD URBANISM

[Incremental Entrepreneurial City]

Meeting Room 2 DEF

Urbanism has been engaged by most municipalities as an apologetic or alternative form of development, to the perceived "market driven" sprawl that most communities face. Yet innovative financial and policy analysis has demonstrated that mixed-use development is not only more beneficial for the environment, but also the fiscally responsible form of growth. This session explores analytic tools, property policy, as well as design strategies that can repair the larger urban fabric. The panel will explain and demystify tax policy, and walk through the communication tools that will help planners and decision makers understand urban design alternatives. We not only focus on solutions to repair our built environment, but to steal a line from the movie Jerry Maguire, we are going to "Show you the money!"

Moderator: Joseph Minicozzi, AICP, New Projects Director, Public Interest Projects, Inc.

Peter Katz, Planning Director, Arlington County; Michael Pagano, Dean, College of Urban Planning and Public Affairs, University of Illinois at Chicago; Galina Tachieva, Partner, Duany Plater-Zyberk & Company

THE NEW TOWN OF CAYALÁ, GUATEMALA

[New Urbanism in the New World]

Meeting Room 1 HI

This session will focus on the design, development, and history of one of the most important New Urbanism projects by Léon Krier in Central America.

Moderator and Presenter: Léon Krier, Architect and Urban Planner Richard Economakis, Associate Professor, University of Notre Dame Pedro Godoy, President, Estudio Urbano; Maria Fernanda Sanchez, Vice President, Estudio Urbano

FROM BALANCED ROADS TO TRANSIT ORIENTED DEVELOPMENT

[Open Innovation]

Meeting Room 1 J

Hear from public, private and Florida Department of Transportation designers and planners about how we can have a more balanced transportation system that recognizes the important role of walking and biking. This session will address topics including: alternatives to wide arterials; transit-oriented developments in Massachusetts and Toronto; fare-free transit; and cycling habits.

Andrew Boenau, Transportation Planning Manager, AECOM; Jessica Hawes, Senior Associate, Brook McIlroy; Kevin Klinkenberg, Senior Planner, Olsson Associates; William Lindeke, PHD Candidate, University of Minnesota; Anne McIlroy, Principal, Brook McIlroy; John Moore, Systems Planner, Florida DOT; George Proakis, AICP, Director of Planning, City of Somerville, MA; David Sajecki, Senior Advisor, Metrolinx

FROM RESEARCH TO PRACTICE: WHAT'S MISSING?

[Sustainability and Livability]

Ballroom C

This session addresses the gap between research findings and practical applications in New Urbanism. Panelists provide insight from the perspective of universities, think tanks, government agencies, and practice in the fields of design, development and law. Participants will briefly present their own experience with the current context as well as best-case scenarios. The majority of the session will engage participants in discussion on future initiatives.

Moderator: Joanna Lombard, Professor, University of Miami
Co-moderator: Stephanie Bothwell, ASLA, Principal, Urban & Landscape Design Jonathan Barnett, Professor of City and Regional Planning, University of Pennsylvania; Lawrence Frank, Ph.D., AICP, CIP, ASLA, President, Urban Design 4 Health

THE MISUNDERSTOOD TRANSECT: THEORY VS. PRACTICE IN NEW URBANIST CODES

10:45 AM-1:30 PM / *Meeting Room 2 ABC*

In early essays on the Transect, some new urbanist theorists described a regional rural-to-urban pattern, as if seen from ten thousand feet. But in current practice, a local Transect is applied at the fine grain of several T-zones per pedestrian shed. To sort out scale confusion and avoid sprawling "place types," this session will trace Transect-based coding from 19th century Natural Transects and context-based zoning codes to the late 20th century Seaside Urban Code and subsequent TND Ordinances, culminating in the 21st century model SmartCode and its controversial Transect diagram. New diagrams will be unveiled.

Moderator: Sandy Sorlien, Transect Codes Council
Andrés Duany, Principal, Duany Plater-Zyberk & Company; Paul Crabtree, P.E., President, Crabtree Group, Inc.

OPEN SOURCE CONGRESS

10:45 AM-5:00 PM / *Meeting Room 1K*

The Open Source Congress is the DIY forum that arises annually during the Congress for the New Urbanism. You can use the time and space to talk about new ideas, find help on a thorny problem, or work on a CNU initiative. Check the schedule on the Open Source news board or follow updates on Twitter at #cnuopen. Then join a session or create one of your own and let the collaboration begin.

META-PHYSICAL PLANNING, ALL YOU NEED IS LOVE

12:30 PM-1:45 PM / *Meeting Room 2 DEF*

Meta-Physical Planning is back for the twentieth anniversary of the Congress for New Urbanism. This year's session will combine themes from past séances: everything is connected, the work of Christopher Alexander, the physical and meta-physical experiences of New Urbanists, stop acting like a Muggle, and all you need is love. The attendees will be the speakers in this open-mike session.

Moderator: John Massengale, Principal, Massengale & Co LLC

AFTERNOON BREAKOUT SESSIONS

2:00 PM-3:15 PM

PRESERVING AFFORDABILITY: GENTRIFICATION WITHOUT DISPLACEMENT

Ballroom A

Too often investments in poor neighborhoods have meant displacement for poor residents. New approaches are needed for transforming neighborhoods of concentrated poverty that do not presume the demolition and replacement of existing housing. Improved urban design, imaginative financing and management practices can offer alternative approaches to troubled public housing developments and create vibrant mixed income buildings and communities. The panel will consider how the most successful ideas around strengthening the sustainability, character and diversity of neighborhoods can be applied to improve the nation's most challenged communities.

Moderator: Alexander Gorlin, FAIA, Principal, Alexander Gorlin Architects
Jacky Grimshaw, Vice President for Policy, Center for Neighborhood Technology; Roseanne Haggerty, President & Founder, Common Ground; Jaimie Ross, Director of Affordable Housing, 1000 Friends of Florida; Alexander von Hoffman, Senior Fellow, Joint Center for Housing Studies, Harvard University

CNU 20 ART ROOM: WATERCOLOR: COMPOSITION AND TECHNIQUE

Meeting Room 1 L

Watercolor painting bridges the gap between hardcore information and artistry. You'll learn how to begin with a quick sketch and value study, and then how to use a simplified palette of watercolors for maximum effect in your painting.

David Csont, Urban Design Associates

MULTIFAMILY RESIDENTIAL BUILDING TYPES FOR AN ENHANCED PUBLIC REALM

[Incremental Entrepreneurial City]

Ballroom C

A growing critique of many larger-scaled new urban developments concerns the quality of the architecture and construction, particularly of multifamily housing. This session explores multifamily building types that can complement or even enhance the public realm of walkable urban places, at every scale, while also satisfying developers' objectives for investment-grade income property or marketable ownership units. How can an understanding of urban residential building types inform more competent urban placemaking? Can better housing prototypes, or assemblages of types, be developed? Are there urban prototypes that can retain the affordability and replicability of conventional product types? How can local planning/zoning agencies be empowered to promote higher design quality in the construction of multifamily building types? Presenters will propose urban structuring solutions including case studies and diagrams, followed by a lively, open debate.

Todd Zimmerman, Co-Managing Director, Zimmerman/Volk Associates Inc; Brian O'Looney, Senior Associate, Torti Gallas and Partners

URBAN FREEWAYS: DEVASTATION AND OPPORTUNITY

[Looking Back, Looking Forward]

Meeting Room 1 HI

This session will explore the history of urban freeways such as Miami's Overtown Expressway, New Orleans' Claiborne Expressway, New Haven's Route 34 and Boston's Big Dig. Panelists will discuss how urban freeways destroyed traditional, often poor, neighborhoods, and what is being done today to repair the urban fabric and make cities whole again.

Moderator: John O. Norquist, President and CEO, Congress for the New Urbanism

John DeStefano, Jr., Mayor of New Haven; Anthony Garcia, Principal, The Street Plans Collaborative; Alison Richardson, Landscape Architect, Brown Richardson & Rowe, Inc.



FLORIDA MOBILITY POLICIES: REGIONAL RAIL TO ENHANCE MOBILITY

[Mobility and the Walkable City]

Meeting Room 2 DEF

For over 40 years, Florida East Coast Rail service has been freight only. The historic Flagler rail corridor originally served every major Gold Coast downtown with passenger rail service.

This session will examine the exciting studies underway to restore stations and rehabilitate community structure to work for pedestrian and rail travel. Treasure Coast Regional Planning Council, and the West Palm Beach MPO, and other regional partners, are collaborating to staff these studies and coordinate with current Tri-Rail service in the corridor. The mobility implications are enhanced by the Florida DoT's support of a three-county rail concept (South Florida East Coast Corridor Study), with regional mobility and economic development implications on a grand scale.

Moderator: Michael J. Busha, AICP, Executive Director, Treasure Coast Regional Planning Council, Kim Delaney, PhD - Strategic Development Coordinator, Treasure Coast Regional Planning Council; Randy Whitfield, P.E. - Executive Director, Palm Beach MPO

RESILIENCE AND ADAPTATION

[Open Innovation]

Meeting Room 1 J

Resilience is the ability of a system to rebound from a negative impact usually based in diversity. Adaptation is accepting and anticipating the need to respond to changing conditions such as new climates. These fearless panelists will address the ways to prepare for and respond to the changing conditions of our world while moving towards more sustainable lifestyles.

Joanna Alimanestianu, Project leader, Bahia Muyuyo project; Keith Bowers, FASLA, RLA, PWS, President, Biohabitats Inc.; Stephen Coyle, AIA, LEED-AP, Owner, Town-Green; Duncan Crary, Host/Producer, KunstlerCast; Scott Douglass, Designer, Duany Plater-Zyberk & Company; Karja Hansen, Director's Fellow, Duany Plater-Zyberk & Company; Seth Harry, AIA, President, Seth Harry & Associates, Inc.; Glenn Kellogg, Principal, UrbanAdvisors Ltd; James Howard Kunstler, Author; Michael Mehaffy, Managing Director, Sustasis Foundation; Robert Orr, FAIA, LEED, Principal, Robert Orr & Associates LLC

MOVING LIFELONG COMMUNITIES TO SCALE

[Sustainability and Livability]

Meeting Room 2 ABC

The long anticipated growth in the older adult population will reach an unprecedented peak over the next two decades. It's clear that the nation's current housing, transportation and healthcare infrastructure will not adequately support the growth in the older adult population. Remarkably, the majority of the innovations in policy, urban design, service delivery and construction have been only locally initiated and rarely replicated at a national scale.

This session will look at the national policy changes necessary to move innovation in neighborhood based care to scale in the areas of Flexible Long Term Care, Housing Finance to Support Housing Choice, and Accessible Environments.

Moderator: M. Scott Ball, Senior Project Manager, Duany Plater-Zyberk & Company Robert Jenkins, Vice President, Community Solutions Group, LLC; Kathryn Lawler, External Affairs Manager, Atlanta Regional Commission

MECHANICAL VS. PASSIVE TECHNOLOGY: LOOKING FOR BALANCE IN BUILDING SCIENCE

[Sustainability and Livability]

Grand Ballroom

This session will discuss tensions between mechanical and passive technologies in commercial and residential buildings. Advocates of passive systems argue that mechanical systems are an unnecessary complication and expensive, often resulting in buildings without the resilience to withstand power interruptions. Advocates of mechanical systems argue that many passive systems are unappealing to the market in many regions with even modest variations in temperature, and that the lack of understanding of humidity results in higher energy bills and mold issues.

Moderator: Elizabeth Plater-Zyberk, Principal, Duany Plater-Zyberk & Company William Browning, Terrapin Founder, Terrapin Bright Green; Ann B. Daigle, Program Manager, Rebuilding Communities Craftsman Apprenticeship, Programme of the Prince's Foundation for the Built Environment and the New Orleans Preservation Resource Center



EXTENDED AFTERNOON BREAKOUT SESSION

2:00 PM-5:00 PM

TODAY'S BEST FORM-BASED CODES

Ballroom B

This session will explore each winning code in-depth, the challenges faced in writing and adopting the code, and the features of the code that make it particularly meritorious. Representatives from the team who wrote and adopted the codes will participate in the session along with Driehaus Form-Based Codes jury members. Questions from those attending the presentation will be sought and answered. This is a hands-on and informative session about best practices in Form-Based Coding.

Eduardo Castillo, Principal, Castillo Arquitectos, Guatemala; Ana Gelabert-Sanchez, AICP, Loeb Fellow at the Graduate School of Design, Harvard University; Robert Sitkowski, Real Estate Officer, University of Connecticut Emily Talen, Ph.D., AICP, Professor, School of Geographical Sciences and Urban Planning, Arizona State University; Carol Wyant, Executive Director, Form-Based Codes Institute

BREAK

3:15 PM-3:45 PM

Grand Ballroom Pre-function Area

LATE AFTERNOON BREAKOUT SESSIONS

3:45 PM-5:00 PM

CNU 20 ART ROOM: OBSERVATIONAL PAINTING IN OILS

Meeting Room 1 L

For years, James Howard Kunstler has used the process of plein air painting in oils to help focus his gaze and clarify his observations of the American built landscape. Please join us as we warmly welcome James Howard Kunstler for a discussion of his observational paintings in oil.

James Howard Kunstler, Author

NEW URBANISM AND HISTORIC PRESERVATION: COLLABORATION STRATEGIES

[Architecture and Placemaking]

Meeting Room 1 HI

While New Urbanism and historic preservation share many values and tools, in practice the two fields have typically acted separately and viewed one another with skepticism. As more new urbanist projects engage existing and historic neighborhoods, and as TNDs become eligible for landmark designation, the need for cooperation between the fields will only increase.

*Moderator: Steven W. Semes, Academic Director, Rome Studies Program, University of Notre Dame
Pratt Cassity, Director, Center for Community Design, University of GA*

FORM-BASED ECONOMIC DEVELOPMENT ON MAIN STREET

[Incremental Entrepreneurial City]

Meeting Room 2 ABC

The utilization of form-based planning and coding as the “master developer” can facilitate the evolution of sustainable neighborhoods and result in value capture for investment in needed infrastructure. Supporting incremental, small scale development, this approach provides opportunities for modest private investments and strategic public investments to create urban development in downtowns and aging commercial corridors, providing for jobs and “Main Street” urban living. Presented by both the designer and developer, the session will be viewed through the lens of a reinvented Main Street in a landlocked aging suburb.

*Monte Anderson, CEO/President, Options Real Estate Investments, Inc.
Scott Polikov, Principal, Gateway Planning Group*

TIME IS ON OUR SIDE

[Incremental Entrepreneurial City]

Ballroom C

Unlike conventional “master-planned” communities—which define land-use and spatial form for all time—New Urbanism established a framework that is inherently flexible and accommodating of changing uses and redevelopment in response to changes in economics, demographics and technology. Time is the enemy of rigid master plans, but the friend and collaborator of the well-conceived urban plan. This session will outline how incremental development tactics harness the benefits of time in a New Urban community and a revitalizing city, focusing on development increments, flexibility and successional development.

*Moderator: Todd Zimmerman, Co-Managing Director, Zimmerman/Volk Associates, Inc.
Barry Alberts, Managing Partner, CityVisions Associates; C. David Coffey, Attorney at Law, C. David Coffey PA*

SEMINAL NEW URBANISM IN THE SUNSHINE STATE: CRITIQUE OF FLORIDA LEGACY PROJECTS SEASIDE, BALDWIN PARK, AND MIZNER PARK, AND HOW THEY ARE SHAPING DEVELOPMENT IN 2012 AND BEYOND

[Looking Back, Looking Forward]

Ballroom A

In this session we examine and critique three seminal Florida projects: Seaside, the first new urban town; Mizner Park, the first total redevelopment of a shopping mall into a town center; and Baldwin Park, the first redevelopment of a military base into a new urban neighborhood.

Moderator: Geoffrey Mouen, Principal, Geoffrey Mouen Architects; Robert Davis, Partner, Seaside Community Development Corporation; Daryl Davis, Partner, Seaside Community Development Corporation; David Pace, New Broad Street Management; Jorge Camejo, Executive Director, Hollywood, Florida, Community Redevelopment Agency; John Torti, FAIA, LEED AP, President, Torti Gallas and Partners

CLEARER THINKING: URBANISM + TRANSIT

[Mobility and the Walkable City]

Meeting Room 2 DEF

There is a serious disconnect between new urbanist designs for communities and the needs of regional transit systems. This is most apparent at the two Charter-defined scales of the neighborhood, district and corridor, and the block, street and building. Transit operations may dictate transit alignment, service and frequency, and these demands are often in conflict with urbanism and local placemaking.

Two of the best thinkers about transit and place will reflect on 20 years of New Urbanism and transit-oriented development (TOD). Panelists will bring their unique perspectives and critiques of the current state of the practice as we've moved from the Pedestrian Pocket, to Transit-Oriented Design, to Development-Oriented Transit.

Moderator: Marcy McInelly, AIA, President, Urbsworks, Inc; G.B. Arrington, Principal Practice Leader Parson Brinckerhoff | PlaceMaking; Jarrett Walker, Consultant in Public Transport Planning and Policy, Jarrett Walker & Associates

GROWING "IN" IN THE 21ST CENTURY: INCREMENTAL GROWTH PATTERNS

[Open Innovation]

Meeting Room 1 J

Redevelopment is changing so that cities need to allow more flexibility for small builders and developers while still creating a harmonious public realm that is sustainable and walkable. From "foot logic" to "living streets," from incremental infrastructure to "radical radials," this group of thinkers will tackle new development paradigms for the new century.

Howard M. Blackson III, Principal, Placemakers, LLC; Brian Canin, AIA, AICP, President, Canin Associates; Paul Crabtree, P.E., President, Crabtree Group, Inc.; Bruce F. Donnelly, Urban Planner, Office of Bruce F. Donnelly; Audun Engh, Project Manager; Aljoscha Hofmann, Dipl. Ing. Arch., TU Berlin, Think Ber!n; Kevin Klinkenberg, Senior Planner, Olsson Associates; Michael Mehaffy, Managing Director, Sustasis Foundation

UNDERSTANDING THE ROLE OF SUSTAINABLE URBANISM IN THE CONSERVATIVE AGENDA

[Sustainability and Livability]

Grand Ballroom

The majority of Americans identify themselves as "conservatives." But this term embraces a broad range that includes fiscal conservatives, social conservatives, Tea Party members, and the Agenda 21 faction. This session will focus on how to communicate the elements of Sustainable Urbanism that advance broad, common agendas, in a way that enables community buy-in. The session will feature conservative journalist Jim Bacon, author of *BoomerGEDdon*, who will be joined by the US Green Building Council's Center for Green School's team, which has led an astonishing transformation of 16.6 million square feet of LEED-certified US educational facilities, 65% of them in the last two years with the support of conservatives in many school districts.

Moderator: Daniel K. Stone, Esquire, Partner, McGuireWoods LLP; James Bacon, Publisher, Bacon's Rebellion; Noland Chambliss, Communications Director, Change.org; Rachel Gutter, U.S. Green Building Council

FRIDAY NIGHT PLENARY WITH RICHARD FLORIDA

5:30 PM-6:30 PM

Grand Ballroom

Richard Florida, author of the best-selling *The Rise of the Creative Class* and *The Great Reset*, will address CNU.

Florida highlights the positive benefits and attractiveness of cities. He argues that urbanism will drive wealth and development in the new economy. His positive views of cities made him popular with mayors and urban advocates across the world - and particularly in America - who have successfully reversed the negative image of urban life that prevailed in the '70s, '80s and early '90s. His research and writing have helped shine a light on cities as the valuable core of a vibrant culture and successful economy. Critics of Florida's pro-urban prescriptions contend that the Creative Class is a proxy for gentrification. Others maintain that "people, not places" develop and question how far a city can rejuvenate itself by focusing on amenities catering to certain demographics.

Come ready to engage with Florida's ideas, which stand in importance alongside urban intellectuals like Ed Banfield and George Kelling. As the Century of the City takes shape, Florida comes to CNU at an opportune time.

Introducer: John O. Norquist, President and CEO, Congress for the New Urbanism

Richard Florida, Founder, Creative Class Group

SALONS

7:30 PM-10:00 PM

O'Shea's Irish Pub, 531 Clematis St., West Palm Beach

A great CNU tradition: tables on a variety of topics hosted by the witty and the wise invite members to meet, brainstorm, and challenge their thinking - aided by a cash bar in the only proper beer garden at O'Shea's Irish Pub in West Palm Beach. Got an idea you want to discuss? Come and host a table on your own topic! Attendance is free, the company is congenial, and the atmosphere is warm. Sign up online at www.cnu20.org

THE ART OF THE NEW URBANISM - EVENING OPEN GALLERY RECEPTION

7:30 PM-10:00 PM

West Palm Beach Lakefront Pavilion, 101 South Flagler Drive

Please come and mingle with the artists of The Art of the New Urbanism during this special evening open gallery reception. The event will begin with a dedication of the exhibit by CNU Chair Victor Dover and special guests. Refreshments courtesy of Bacardi U.S.A., Inc. will be served in The Art of the New Urbanism exhibit gallery.

CNU 20 AT A GLANCE

WEDNESDAY

Date	Time	Session Title	Room
Tuesday 5/8	5:00 PM - 7:00 PM	Congress Registration	Convention Center Main Lobby
	7:00 AM - 7:00 PM	Congress Registration	Convention Center Main Lobby
Wednesday 5/9	8:00 AM - 9:00 AM	Breakfast	Grand Ballroom Pre-function Area
	9:00 AM - 12:00 PM	New Urbanism 101	Ballroom C
		202 A: CNU/ITE Recommended Practice, Designing Walkable Urban Thoroughfares	Meeting Room 1 D
		202 C: Sprawl Retrofit: Corridors as the Thread That Tie Everything Together	Meeting Room 1 E
		202 D: Planning & Redevelopment Strategies for Streets Intersecting Main Street	Meeting Room 1 C
	9:00 AM - 1:00 PM	202 B: SmartCode Calibration Workshop	Meeting Room 1 B
	9:00 AM - 5:00 PM	The Next Generation of New Urbanists: A One-Day Congress	Ballroom B
	9:30 AM - 11:30 AM	Guided Tour: Palm Beach Urban Gardens	Convention center main entrance (Okeechobee Blvd)
	1:00 PM - 5:00 PM	Guided Tour: Abacoa	
		Guided Tour: Delray Beach: "Style without Attitude"	
	2:00 PM - 5:00 PM	202 E: Principles of Urban Retail Planning & Development	Meeting Room 1 F
		202 F: Traffic Safety and Urban Design	Meeting Room 1 D
		202 H: Smart Growth A to Z	Meeting Room 1 E
		202 I: The Criticality of Quality Architecture - Adding Value in a Down Market	Meeting Room 1 C
	5:00 PM - 8:00 PM	Exhibits	Grand Ballroom Pre-function Area
	5:30 PM - 6:30 PM	Opening Plenary: Twenty Years of The CNU: Looking Back, Looking Forward	Grand Ballroom
	6:30 PM - 8:00 PM	Exhibits Reception	Grand Ballroom Pre-function Area
Thursday 5/10	7:00 AM - 7:00 PM	Congress Registration	Convention Center Main Lobby
	8:00 AM - 8:30 AM	Orientation Breakfast for First-Time Attendees	Meeting Room 2 DEF
	8:00 AM - 9:00 AM	Breakfast	Grand Ballroom Pre-function Area
	8:00 AM - 3:45 PM	Exhibits	Grand Ballroom Pre-function Area
	8:30 AM - 9:00 AM	Meet the Candidates: CNU Board Elections	Grand Ballroom
	9:00 AM - 12:00 PM	Looking Forward: New Urbanism and the New World	Grand Ballroom
	12:00 PM - 1:30 PM	Guided Tour: Clematis Street Walking Tour (Thursday)	Convention center main entrance (Okeechobee Blvd)
	12:15 PM - 1:45 PM	2012 Charter Awards	Offsite: The Harriet Himmel Theater
	1:00 PM - 3:00 PM	Guided Tour: Historic Palm Beach Walking Tour	Convention center main entrance (Okeechobee Blvd)
	2:00 PM - 3:15 PM	CNU 20 Art Room: Photographing the Building, Street, and Town	Meeting Room 1 L
		Parking: Planning to Store the Cars Properly Amidst the Pedestrians!	Ballroom C
		Space, the First but Not Final Frontier: Analyzing Space, Uses, and Transportation	Meeting Room 2 DEF
		The Real Deal: Implemented Incremental Urbanism	Ballroom A

THURSDAY

Friday 5/11

FRIDAY

2:00 PM - 3:15 PM	The Secret Life of Trees Too Much Water or Too Little? Using the Landscape to Advance Regional Sustainability Without Destroying Urbanism: A Florida Transect Where is the Market Taking Us?	Grand Ballroom Meeting Room 2 ABC Ballroom B
2:00 PM - 5:00 PM	202 J: How to Lease a Town Center with Proven Results- The Restaurant Effect Open Source Congress	Meeting Room 1 HI Meeting Room 1 K
3:00 PM - 8:00 PM	The Art of the New Urbanism	Offsite: West Palm Beach Lakefront Pavilion
3:15 PM - 3:45 PM	Break (Refreshment provided)	Grand Ballroom Pre-function Area
3:30 PM - 5:00 PM	Guided Tour: CityPlace: 12 Years After Sponsored by Carlton Fields	Convention center main entrance (Okeechobee Blvd)
3:45 PM - 5:00 PM	CNU 20 Art Room: Rendering in Pen and Ink Heterodoxia Architectonica Making Urban Facades Pro Formas for the Rest of Us	Meeting Room 1 L Room 2ABC Ballroom A Meeting Room 2 DEF
	Two Traditions of Latin American Urbanism	Ballroom B
	Why Did We Stop Walking & How Do We Start Again? The Dawn of the Motor Age in the American City	Ballroom C
	Why We Write: Prominent New Urbanist Authors Discuss Their Classic NU Books and Current Works, and the Critical Importance of Writing to the Movement	Grand Ballroom
5:30 PM - 6:30 PM	Athena Medal Awards Plenary: The Uniqueness of Urban Design	Offsite: The Harriet Himmel Theater
7:30 PM - 10:00 PM	Chapter Meet-Ups	Offsite: various locations
7:30 AM - 7:00 PM	Congress Registration	Convention Center Main Lobby
8:00 AM - 9:00 AM	Breakfast	Grand Ballroom Pre-function Area
8:00 AM - 5:30 PM	Exhibits	Grand Ballroom Pre-function Area
9:00 AM - 10:15 AM	Friday Morning Gathering and Photo	Grand Ballroom
10:15 AM - 10:45 AM	Break (Refreshment provided)	Grand Ballroom Pre-function Area
10:30 AM - 1:30 PM	Guided Tour: CityPlace/Clematis Street Walking Tour	Convention center main entrance (Okeechobee Blvd)
10:45 AM - 12:00 PM	CNU 20 Art Room: SketchUp as a Foundation for Quick Charrette Hand Drawing From Balanced Roads to Transit-Oriented Development From Research to Practice: What's Missing? Philanthropy and the New Urbanism The Economic Benefit of Good Urbanism The New Town of Cayalá, Guatemala	Meeting Room 1 L Meeting Room 1 J Ballroom C Ballroom A
10:45 AM - 1:30 PM	The Misunderstood Transect: Theory vs. Practice in New Urbanist Codes	Meeting Room 2 DEF Meeting Room 1 HI
10:45 AM - 5:00 PM	Open Source Congress	Meeting Room 2 ABC
12:30 PM - 1:45 PM	Meta-Physical Planning, All You Need Is Love	Meeting Room 1 K Meeting Room 2 DEF

CNU 20 AT A GLANCE

FRIDAY

Date	Time	Session Title	Room
	2:00 PM - 3:15 PM	CNU 20 Art Room: Watercolor: Composition and Technique	Meeting Room 1 L
		Florida Mobility Policies: Regional Rail to Enhance Mobility	Meeting Room 2 DEF
		Mechanical vs. Passive Technology: Looking for Balance in Building Science	Grand Ballroom
		Moving Lifelong Communities to Scale	Meeting Room 2 ABC
		Multifamily Residential Building Types for an Enhanced Public Realm	Ballroom C
		Preserving Affordability: Gentrification without Displacement	Ballroom A
		Resilience and Adaptation	Meeting Room 1 J
		Urban Freeways: Devastation and Opportunity	Meeting Room HI
	2:00 PM - 4:00 PM	Guided Tour: Bike Tour of Palm Beach	Convention center main entrance [Okeechobee Blvd]
	2:00 PM - 5:00 PM	Guided Tour: Historic Neighborhoods and Bed & Breakfasts Tour	Convention center main entrance [Okeechobee Blvd]
		Today's Best Form-Based Codes	Ballroom B
	3:15 PM - 3:45 PM	Break (Refreshment provided)	Grand Ballroom Pre-function Area
	3:45 PM - 5:00 PM	Clearer Thinking: Urbanism + Transit	Meeting Room 2 DEF
		CNU 20 Art Room: Observational Painting in Oils	Meeting Room 1 L
		Form-Based Economic Development on Main Street	Meeting Room 2 ABC
		Growing "In" in the 21st Century: Incremental Growth Patterns	Meeting Room 1 J
		New Urbanism and Historic Preservation: Collaboration Strategies	Meeting Room 1 HI
		Seminal New Urbanism in the Sunshine State: Critique of Florida Legacy Projects Seaside, Baldwin Park, and Mizner Park, and How They are Shaping Development in 2012 and Beyond	Ballroom A
		Time is on Our Side	Ballroom C
		Understanding the Role of Sustainable Urbanism in the Conservative Agenda	Grand Ballroom
	4:00 PM - 6:00 PM	The Art of the New Urbanism	Offsite: West Palm Beach Lakefront Pavilion
	5:30 PM - 6:30 PM	Friday Night Plenary with Richard Florida	Grand Ballroom
	7:30 PM - 10:00 PM	Salons	O'Shea's Irish Pub
		The Art of the New Urbanism - Evening Open Gallery Reception	West Palm Beach Lakefront Pavilion
	9:30 PM - 11:30 PM	Guided Tour: Worth Avenue: After-Hours Street-Level Merchandising Tour	Convention center main entrance [Okeechobee Blvd]
Saturday 5/12	7:00 AM - 7:00 PM	Congress Registration	Convention Center Main Lobby
	8:00 AM - 9:00 AM	Breakfast	Grand Ballroom Pre-function Area
	9:00 AM - 10:15 AM	Saturday Morning Plenary Featuring Léon Krier	Grand Ballroom
	10:15 AM - 10:45 AM	Break (Refreshment provided)	Grand Ballroom Pre-function Area
	10:15 AM - 11:45 AM	Guided Tour: Clematis Street Walking Tour (Saturday)	Convention center main entrance [Okeechobee Blvd]
	10:30 AM - 5:00 PM	Guided Tour: Treasure Coast Tour: Ft. Pierce and Stuart	Convention center main entrance [Okeechobee Blvd]

10:45 AM - 12:00 PM	CNU 20 Art Room: Architectural Rendering in Watercolor Wash and Evocative Pastel Travel Sketching Hispaniola: Birthplace of the Latin American City Functional Classification: The Least Interesting Policy That Dominates Most Everything Rainwater-In-Context Speed Presentation Tactical Urbanism, Economics and Community The Paradox of Emerging Cities To the Developing World and Back Again: The International Application of New Urbanism West Palm Story: Downtown Back from the Brink Open Source Congress AuthentiCity West Palm Beach Competition: Judging Panel Live Work Walk Initiative Meeting Planners Initiative Meeting Project for Transportation Reform Initiative Meeting Rainwater-In-Context Initiative Meeting Sprawl Retrofit Initiative Meeting A Brief History of the New World Across the Transect: From Historic Preservation to Composting Charrettes and the Next Generation of Public Involvement CNU 20 Art Room: Digital Painting with the iPad and with Photoshop Designing and Developing Walkable Urban Grocery Stores Realizing Streets for Everyone, and Getting Someone Else to Pay for Them: Funding, Designing and Implementing Complete Streets Seaside 30th Anniversary: Architecture Can Transcend Style The Reality of Live-Work Today Break (Refreshment provided) Achieving Sustainable Communities Beyond Bike Lanes: Building a Culture of Bicycle Safety CNU 20 Art Room: Photo-Realistic Before and After Sequences in Photoshop Global Capitalism & The Tall Tower Reconsidered Havana: Paradigm of a Caribbean City Small is Beautiful: Local Economic Networks of the Pre-Auto Era Sprawl Repair and Infill: From Incremental to Retrofit to Agriculture The Art of the New Urbanism Saturday Night Closing Plenary: Memo for the Next Decade Closing Event	Meeting Room 1 L Ballroom C Meeting Room 2 DEF Ballroom B Meeting Room 1 J Grand Ballroom Meeting Room 2 ABC Ballroom A Meeting Room 1 K Meeting Room 1 J Meeting Room 2 ABC Ballroom C Meeting Room 2 DEF Ballroom B Ballroom A Meeting Room 2 ABC Meeting Room 1 J Ballroom A Meeting Room 1 L Ballroom B Meeting Room 2 DEF Grand Ballroom Ballroom C Grand Ballroom Pre-function Area Ballroom A Meeting Room 2 DEF Meeting Room 1 L Ballroom B Meeting Room 2 ABC Ballroom C Meeting Room 1 J Offsite: West Palm Beach Lakefront Pavilion Grand Ballroom Offsite: Roxy's Pub
10:45 AM - 5:00 PM		
12:30 PM - 1:45 PM		
2:00 PM - 3:15 PM		
3:15 PM - 3:45 PM		
3:45 PM - 5:00 PM		
5:00 PM - 9:00 PM		
5:30 PM - 6:30 PM		
7:30 PM - 11:00 PM		
9:00 AM - 5:00 PM	Guided Tour: Windsor	Convention center main entrance (Okeechobee Blvd)

Sunday 5/13

SATURDAY

SATURDAY MAY 12

CONGRESS REGISTRATION

7:30 AM - 7:00 PM

Convention Center Main Lobby

CHAPTERS BREAKFAST

8:00 AM-8:45 AM

Meeting Room 1L

The Chapters Steering Committee will meet for a business breakfast to discuss monthly operations and capacity-building work. This meeting has a special focus on connecting initiative work to Chapter members and local efforts to implement New Urbanism.

BREAKFAST

8:00 AM-9:00 AM

Grand Ballroom Pre-function Area

SATURDAY MORNING PLENARY FEATURING LÉON KRIER

9:00 AM-10:15 AM

Grand Ballroom

The Charter of the New Urbanism has proven to be a durable, living document throughout its existence. However, two issues have been left unresolved: the limit of high density and related number of floors, and the issue of style, building technology, methods and materials.

Even if there were no limit on energy consumption, no limit on the mechanization of transport, horizontal or vertical, and even if there existed no limit on production of more and better-performing synthetic building materials, we should still design and build to walkable building heights (a maximum of five floors), and use natural building materials and traditional building methods and styles. Even if we are in a situation of extreme mechanization and synthetic building materials, we should still build walkable building heights and use traditional building typology, vocabulary, styles and methods. The humanness of building-scale, methods and styles is dependent on these points of doctrine. Previous CNU Athena Medal honoree, architect, and planner Léon Krier will discuss these issues, their interrelation, and why they need to be faced.

Introducer: Dhiru Thadani, AIA, Architect + Urbanist

Léon Krier, Architect and Urban Planner

Léon Krier's participation in CNU 20 was made possible by Windsor.

GUIDED TOURS

All depart from and return to the convention center main entrance (Okeechobee Blvd). Require registration and a separate fee.

10:15 AM-11:45 AM / Clematis Street Walking Tour (Saturday)

10:30 AM-5:00 PM / Treasure Coast Tour: Ft. Pierce and Stuart

BREAK

10:15 AM-10:45 AM

Grand Ballroom Pre-function Area

MORNING BREAKOUT SESSIONS

10:45 AM-12:00 PM

TO THE DEVELOPING WORLD AND BACK AGAIN: THE INTERNATIONAL APPLICATION OF NEW URBANISM

Meeting Room 2 ABC

This session will showcase research on the relationship between urban form and New Urbanism. A number of papers were selected for their academic rigor, originality, scholarship, and creativity. If you are interested in the most recent urban form investigations and trends, you won't want to miss this session!

Moderator: Jaime Correa, Founding Partner, Jaime Correa and Associates Patricia Glanville, Heritage Architect, Ministry of Tourism Parks Culture and Sport; Dipu Gupta, Adjunct Professor of Architecture & Urbanism, University of California, Merced; Sheuli Mitra, Associate Professor in Planning, Department of Planning, School of Planning and Architecture, Bhopal, India; Tapas Mitra, Assistant Professor in Architecture, Department of Architecture, School of Planning and Architecture, Bhopal, India; Lesley Pories, Candidate, Master of City and Regional Planning (2013), University of North Carolina at Chapel Hill

CNU 20 ART ROOM: ARCHITECTURAL RENDERING IN WATERCOLOR WASH

Meeting Room 1 L

Learn the fundamentals of this classic watercolor rendering process. Techniques demonstrated will include drawing setup, running a basic wash, laying a graded wash, painting skies with clouds, and conventions for painting reflected light, shades, and shadows.

John Griffin, Torti Gallas and Partners; Jennifer Griffin, Hartman-Cox Architects

CNU 20 ART ROOM: EVOCATIVE PASTEL TRAVEL SKETCHING

Meeting Room 1 L

Soft pastels are a vivid medium well-suited to the representation of architecture through luminous fields of color. Learn to use pastels when you travel to capture the fleeting play of light on urban space through blending, texture, and layering.

Andrew Georgiadis, Dover, Kohl & Partners

THE PARADOX OF EMERGING CITIES [Architecture and Placemaking]

Grand Ballroom

Cities all over the world are transforming at rapid rates, responding to population growth, energy crisis, transportation, and demographic shifts. Several cities will be discussed in this session: Dubai, a city of superhighways, superblocks and super high-rises, is rapidly developing in a disconnected pattern of homogenous enclaves. This paradigm undermines physical accessibility by pedestrians, automobiles, and public and private transit. The result is an environment with no inherent vibrancy or the sustainability of compact, complex, complete, and equitable urbanism. Huxindao Island in Xiamen, a major coastal city in southern China, is the site for 2 million square feet of high-density development. This planned community adapts to issues of local culture, climate, technology, and incorporates an architectural vocabulary found in both traditional Chinese and Mediterranean architecture.

Moderator: Daniel Solomon, Principal, Daniel Solomon Design Partners Paul Whalen, AIA, Partner, Robert A.M. Stern Architects LLP; Douglas Kelbaugh, FAIA, Professor of Architecture and Urban Planning, Taubmann College of Architecture and Urban Planning, University of Michigan

WEST PALM STORY: DOWNTOWN BACK FROM THE BRINK
[Incremental Entrepreneurial City]

Ballroom A

Twenty years ago, downtown West Palm Beach was dying. Clematis Street, like Main Streets across the country, was failing. Where CityPlace now stands, 14 city blocks of intact urbanism had been razed for a failed redevelopment scheme.

This session will describe how dynamic city leaders and a foresighted planning team turned downtown around, with particular attention to the role played by a pioneering Form-Based Code. A panel of local experts will add their personal insights, including thoughts on the latest downtown master plan and code.

Moderator: Bill Spikowski, AICP, Principal, Spikowski Planning Associates
Anthea Gianniotis, AICP, Urban Designer/Town Planner, Treasure Coast Regional Planning Council; Dana Little, Urban Design Director, Treasure Coast Regional Planning Council; Joseph Minicozzi, AICP, New Projects Director, Public Interest Projects, Inc.; Kimberly Mitchell, City Commissioner, City of West Palm Beach; Joseph Verdone, AICP, Carlton Fields

HISPANIOLA: BIRTHPLACE OF THE LATIN AMERICAN CITY
[New Urbanism in the New World]

Ballroom C

Hispaniola was discovered by Christopher Columbus in 1492, and was the first island in the New World settled by the Spanish. Scattered across the island, the Spanish left behind town layouts that reflected their cultural heritage. In what is now known as the Dominican Republic, nearly 60% of residents live in urban areas. The western end of Hispaniola, more commonly known as Haiti, has blended French and southern United States Victorian architectural styles over a gridiron urban pattern in its cities. This session will explore recent interventions in Santo Domingo and Haiti.

Moderator: Sonia Chao, Director, Center for Urban and Community Design
Carmen Guerrero, Victor Santana

TACTICAL URBANISM, ECONOMICS AND COMMUNITY
[Open Innovation]

Meeting Room 1 J

Make change faster, engage many voices and show us the money. This three-fold session allows you to participate in workshopping the latest ideas with the leading voices in the Tactical Urbanism initiative, engage in new ways of thinking about community and community engagement and address the economics of entertainment districts and of sprawl.

Randall Anway, Principal, New Tapestry LLC; Anthony Garcia, Principal, The Street Plans Collaborative; Nathaniel Hood, Urban/Transportation Planner; Kristen Jeffers, Grassroots Planner and Placemaker; Mike Lydon, Principal, The Street Plans Collaborative; Russell S. Preston, Design Director, Principle Group; Ralph Rosado, Director of Urban Planning & Grants Services at C3TS; Rick Rybeck, Director, Just Economics LLC

FUNCTIONAL CLASSIFICATION: THE LEAST INTERESTING POLICY THAT DOMINATES MOST EVERYTHING

[Mobility and the Walkable City]

Ballroom C

Functional Classification, the conceptual basis behind highway, street and network planning, also impacts all transit planning, determines bicycle solutions, and unknowingly, establishes where we can walk. Even zoning ordinances and comprehensive plans are tied to functional classification. This session presents a brief history of functional classification in planning, its detrimental impacts to urbanism, and explores alternative classification and planning ideas that can promote more livable, walkable streets and sustainable cities.

Laurence Aurbach, Editor and Researcher, Office of Laurence Aurbach; Richard Hall, P.E., President, Hall Planning & Engineering Inc.



RAINWATER-IN-CONTEXT SPEED PRESENTATIONS

[Sustainability and Livability]

Ballroom B

Leaders of CNU's Rainwater-In-Context initiative report from the stormfront of Green Infrastructure and Community Design in a lightning fast presentation. Learn how New Urbanists respond to the tsunami of surface water runoff regulations. Following the presentation, attendees will participate in a working meeting.

Steve Coyle, Principal, Town-Green; Paul Crabtree, P.E., President, Crabtree Group, Inc.; Dao Doan, CFO/Senior Principal, Mainstreet Architects + Planners, Inc.; Jonathan Ford, Principal, Morris Beacon Design; Tom Low, Partner, Director of Town Planning, Duany Plater-Zyberk & Company; Lisa Nisenson, Principal, Nisenson Consulting; Lynn Richards, Policy Director, USEPA - Office of Sustainable Communities; Kent Schwendy, Sr VP, Fuss & O'Neill Inc.; Brian Teague, PE CNU, Director of Design, Community by Design

OPEN SOURCE CONGRESS*Meeting Room 1K*

The Open Source Congress is the DIY forum that arises annually during the Congress for the New Urbanism. You can use the time and space to talk about new ideas, find help on a thorny problem, or work on a CNU initiative. Check the schedule on the Open Source news board or follow updates on Twitter at #cnuopen. Then join a session or create one of your own and let the collaboration begin.

AUTHENTICITY WEST PALM BEACH COMPETITION: JUDGING PANEL**12:30 PM-1:45 PM***Meeting Room 1 J*

CNU, the City of West Palm Beach, and Authenticity have sponsored an open design competition intended to apply CNU's collective expertise in giving back to the local community. West Palm Beach has the distinct advantage of connected in-town neighborhoods, however these connections and neighborhood structures have decayed. We have challenged entrants to propose realistic and incremental solutions to repair and reconnect two of these in-town neighborhoods. Join us for our final judging panel, an open critique of competition submissions by our judging team.

Matthew Lambert, Partner, Duany Plater-Zyberk & Company; Russell S. Preston, Design Director, Principle Group

INITIATIVE MEETINGS**12:30 PM-1:45 PM**

This is your chance to get updates on the latest CNU initiatives that advance the practice of New Urbanism throughout the year. Whether it is updates on Rainwater-in-Context, Highways-to-Boulevards, or the Project for Transportation Reform, this is your opportunity to hear the latest. Bring your lunch and join the movement leaders. Lunch will be available for purchase in the Grand Ballroom pre-function area.

PROJECT FOR TRANSPORTATION REFORM INITIATIVE MEETING*Meeting Room 2 DEF*

The Project for Transportation Reform (PTR), a CNU initiative promoting the implementation of connected, multi-modal street networks as the answer to many of our transportation, safety, land use and urban design problems, has made a great deal of progress since its initiation. Network connectivity has been demonstrated to increase pedestrian safety, increase vehicular capacity, reduce emergency response time, create higher land values, and promote economic viability of cities, towns and main streets. Join us for a working session featuring updates on the Sustainable Street Network Principles. Art Cueto of Alta Planning will give a preview of the September 9-10, 2012 Long Beach, CA Transportation Summit.

Marcy McInelly, AIA, President, Urbsworks, Inc.

**RAINWATER-IN-CONTEXT INITIATIVE MEETING***Ballroom B*

Following the previous session, attendees will participate in a working session for the Rainwater-In-Context initiative. The session will discuss the current status of EPA stormwater rulemaking and the initiative's next steps. Attendees will also discuss how the Initiative can inform widespread implementation of small area design through the creation of a guide for decision-makers.

PLANNERS INITIATIVE MEETING*Ballroom C*

Can the urbanists add the missing ingredients to America's uninspired, perfunctory comprehensive plans? An interactive conversation with the American Planning Association's top leader on the role of New Urbanism in the next generation of comprehensive plans.

Special Guest: Mitchell Silver, AICP, APA President; Planning Director, City of Raleigh

Victor Dover, CNU-A, Principal, Dover, Kohl & Partners; Gianni Longo, Principal, ACP Visioning & Planning

LIVE/WORK/WALK INITIATIVE MEETING

Meeting Room 2 ABC

Since the advent of FHA in the 1930s, federal housing financing regulations have encouraged a separation of residential and commercial uses. Restrictions on the commercial component of space attached and/or adjacent to housing have promoted sprawl as the prevailing pattern of land-use development. These regulations have left a legacy that still inform financing standards in place by FHA, Fannie Mae, Freddie Mac and HUD's 221d4 and 220 programs. This session will explore the creation of a new 'asset class' that will allow for the successful financing of mixed-use developments and Live/Work/Walk districts – a return to Main St.-style communities.

John O. Norquist, President and CEO, Congress for the New Urbanism

SPRAWL RETROFIT INITIATIVE MEETING

Ballroom A

Can we heal our sprawling communities through retrofit, repair and redevelopment? This working group will review new ideas in sprawl retrofit design, regulation, and implementation to achieve healthier communities. Attendees will discuss approaches to incremental sprawl repair, corridor retrofits, regional strategies and financial approaches building on work completed during the March Retreat in Miami. Initiative members will report on a series of practical toolkits, newly formed partnerships and an overall strategic plan and next steps for the upcoming year.

Ellen Dunham-Jones, Professor of Architecture and Urban Design, Georgia Institute of Technology

AFTERNOON BREAKOUT SESSIONS

2:00 PM-3:15 PM

CNU 20 ART ROOM: DIGITAL PAINTING WITH THE IPAD AND WITH PHOTOSHOP

Meeting Room 1 L

Digital painting is a powerful new tool full of possibilities for urban illustrators. The first half of this session will demonstrate rapid application of color to an image using the iPad. In the second half, more detailed digital painting techniques with Photoshop will be explored.

John J Zanetta; Joe Skibba

SEASIDE 30TH ANNIVERSARY: ARCHITECTURE CAN TRANSCEND STYLE [Architecture and Placemaking]

Grand Ballroom

With the 30th anniversary of Seaside in 2011, the "inaugural" New Urbanism project theoretically becomes eligible for designation as a historic district. Seaside was the first on many fronts:

- 1) The original graphic code led to the development of form-based codes.
- 2) The architectural code recovered an interest in vernacular architecture.
- 3) Prudent financial planning underpinned many sustainability concepts.
- 4) The use of native species is now commonly referred to as Xeriscape.

This session will take a close look at Seaside and examine its influence and transcendence from style to a movement.

Moderator: Robert Davis, Partner, Seaside Community Dev. Corp (SCDC) Arcadia Land Company

Walter Chatham, Walter Chatham Architect; Alexander Gorlin, FAIA, Principal, Alexander Gorlin Architects; Scott Merrill, Merrill, Pastor & Colgan Architects

planning
and
designing

great people places

CANIN ASSOCIATES

urban planning • landscape architecture • architectural design

500 delaney avenue orlando, florida 32801 407.422.404C

www.canin.com



SATURDAY

THE REALITY OF LIVE-WORK TODAY

[Incremental Entrepreneurial City]

Ballroom C

To coincide with the release of the first book on live-work - to be published in April - this session will detail the range of live-work types, from the loft to the flexhouse. The evolution and challenges of this flexible development type will be presented by the book's author, architect Thomas Dolan, including a discussion of the live-work market and development experience.

Moderator: Todd Zimmerman, Co-Managing Director, Zimmerman/Volk Associates, Inc.

Tom Dolan, CNU-A, Principal, Thomas Dolan Architecture; Frank Starkey, President, Longleaf Development Co.

DESIGNING AND DEVELOPING WALKABLE URBAN GROCERY STORES [Incremental Entrepreneurial City]*Ballroom B*

Developing supermarkets in urban, mixed-use structures comes with a unique set of demands and challenges. It takes work to distinguish such stores from suburban stand-alone structures and further, differentiating such developments from other mixed-used structures. This session, which combines a regional supermarket operator, a national mixed-use developer and an architect for such mixed-use structures, will highlight the multiple aspects of this product type's delivery and operations.

Moderator: Neal Payton, AIA, Principal, Torti Gallas and Partners, Inc.

John Given, Principal, Investment & Development, CIM Group; David Taulbee, AIA, Architectural Manager, Publix Super Markets Inc.

CHARRETTEs AND THE NEXT GENERATION OF PUBLIC INVOLVEMENT [Incremental Entrepreneurial City]*Ballroom A*

Are the days of the seven-day charrette behind us? Shrinking budgets, social media, tea party obstruction... it's time to take another look at charrettes and public involvement.

How can high-tech tools such as social media and online meetings be leveraged to increase the number and diversity of people that are engaged in planning projects, while still maintaining the advantages of face-to-face meetings? This session will present the latest tools, techniques and the trade-offs of social media and web-base participation tools within the context of the face-to-face public design charrette format.

Moderator: Bill Lennertz, Executive Director, National Charrette Institute

Hazel Borys, Managing Principal, PlaceMakers

Ben Brown, Consultant, PlaceMakers LLC; Andrés Duany, Principal,

Duany Plater-Zyberk & Company; Gianni Longo, Principal, ACP

Visioning & Planning

REALIZING STREETS FOR EVERYONE, AND GETTING SOMEONE ELSE TO PAY FOR THEM: FUNDING, DESIGNING AND IMPLEMENTING COMPLETE STREETS

[Mobility and the Walkable City]

Meeting Room 2 DEF

States and local jurisdictions are using Complete Streets policies and principles to enable walkable communities. The result is a paradigm shift in the way jurisdictions approach transportation planning, requiring an integrated land use/transportation approach that is often characterized by the charrette process, ensuring that the public street realm is designed holistically in context with overall placemaking. Many jurisdictions are turning to mechanisms such as Form-Based Codes to ensure that Complete Streets principles are integrated into planning for small and large areas. This session will discuss untraditional funding such as public-private partnerships and other techniques to implement Complete Streets, including developing competitive projects for programs such as TIGER and Sustainable Community Challenge Grants.

Moderator: Frederick Schwartz, Senior Vice President, Kimley-Horn and Associates, Inc

Kim Briesemeister, CRA Director, Redevelopment Manager, City of West

Palm Beach CRA; Adam Kerr, Transportation Engineer, Kimley-Horn and

Associates, Inc; G. Wade Walker, Director of Transportation Planning, Fuss &

O'Neill; Matt Ward, CEO, Sustainable Strategies DC

A BRIEF HISTORY OF THE NEW WORLD

[New Urbanism in the New World]

Meeting Room 2 ABC

This session will survey aspects of the history of Latin American architecture and urbanism: the colonial city, the suburban expansion of the metropolis, the foundation of new modern cities in terra incognita, and the era of transect transgressions and informalities on the periphery.

Moderator: Jaime Correa, Founding Partner, Jaime Correa and Associates

Ramon Abonce, Director of Architecture and New Urbanism Masters

Program, Tecnológico de Monterrey Campus Queretaro; Adib Cure;

Seth Harry, AIA, President, Seth Harry & Associates, Inc.; Jean-Francois

LeJeune, Professor and Director of Graduate Studies, University of Miami;

Professor Claudia Ortiz, Director, Master in Architecture and New Urbanism,

Instituto Politécnico de Monterrey in Queretaro





ACROSS THE TRANSECT: FROM HISTORIC PRESERVATION TO COMPOSTING

[Open Innovation]

Meeting Room 1 J

From the Prince’s Foundation work in the Galapagos Islands to historic Miami neighborhoods to composting across the “Trashy Transect,” sample the wide variety of ways in which practitioners are balancing natural habitats with human habitats. Tackle high and low tech transect analysis with “Geeks and Grounders” from GIS automation to photographic DNA.

Alexander Adams, Preservation Officer, City of Miami; Hector Fernando Burga, Co-Founder Up-Lab, Up-lab; Peter Quinatnilla, Senior Design Advisor, The Prince’s Foundation; Samantha Singer, Urban Project Manager, The Prince’s Foundation; Jennifer Siqueira, Co-Founder Up-Lab, Up-Lab; Sandy Sorlien, Transect Codes Council; Emily Talen, Ph.D., AICP, Professor, School of Geographical Sciences and Urban Planning, Arizona State University

BREAK

3:15 PM-3:45 PM

Grand Ballroom Pre-function Area

LATE AFTERNOON BREAKOUT SESSIONS

3:45 PM-5:00 PM

GLOBAL CAPITALISM & THE TALL TOWER RECONSIDERED

Ballroom B

Recent trends in New Urbanism include regional and local economies, the Citta Slow and the Original Green. Hot trends in avant garde architecture and urbanism include Platinum skyscrapers and high-profile American firms working in Asia and the Middle East. In this session, CNU Founder Stefanos Polyzoides FAIA will debate the High Rise in Urbanism with New York planner, academic and former developer Vishaan Chakrabarti and James von Klemperer FAIA, Design Principal at Kohn Pedersen Fox (KPF). Fireworks are expected.

*Moderator: John Massengale, Principal, Massengale & Co LLC
Vishaan Chakrabarti, Marc Holliday Associate Professor of Real Estate Development GSAPP, Columbia University; PPeter Fleischer, Executive Director, Empire State Future; Stefanos Polyzoides, Principal, Moule & Polyzoides Architects & Urbanists; James von Klemperer, Kohn Pedersen Fox Associates PC*

CNU 20 ART ROOM: PHOTO-REALISTIC BEFORE AND AFTER SEQUENCES IN PHOTOSHOP

Meeting Room 1 L

Learn to construct a convincing change-over-time transformation in Photoshop. Techniques covered will include: placing architecture, creating realistic shadows, adding paving and roadway markings in perspective, placing trees, and other tricks of the trade.

Steve Price, Owner, Illustrator, Urban Advantage Inc.



SMALL IS BEAUTIFUL: LOCAL ECONOMIC NETWORKS OF THE PRE-AUTO ERA [Looking Back, Looking Forward]

Ballroom C

There was a time, before 1940, when local networks of economic interdependence fueled small-scale urbanism that benefited and enhanced great urban goals. Find out how cities functioned before the 1940's. How can we return to this system of interdependence? And how can placemaking contribute to that transformation?

Moderator: Emily Talen, Ph.D., AICP, Professor, School of Geographical Sciences and Urban Planning, Arizona State University
Robert Fishman, Professor and Author, University of Michigan, Taubman College of Architecture and Urban Planning, Bourgeois Utopias: The Rise and Fall of Suburbia; James Howard Kunstler, Author; Kimber Lanning, Director, Local First Arizona

BEYOND BIKE LANES: BUILDING A CULTURE OF BICYCLE SAFETY [Mobility and the Walkable City]

Meeting Room 2 DEF

Cycling is catching on as a viable alternative to the automobile. Bicycle commuting increased by more than 60% between 2000 and 2010 in the 70 largest cities in the U.S. Nonetheless, cycling can be deadly, particularly in Florida, which is home to the four most dangerous cities for pedestrians and cyclists. While New Urbanists have been at the forefront of efforts to promote bicycle infrastructure, simply building bike lanes is not enough to reduce cycling-related deaths and injuries. In this session we will hear from leaders at the forefront of Florida's bicycle safety movement and discuss strategies for combining infrastructure, programming, advocacy, and policy to create a broader culture of bicycle safety.

Moderator: DeWayne Carver, AICP - Senior Project Manager, Hall Planning & Engineering, Inc.

Keri Caffrey, Co-founder, CyclingSavvy; Eric Dumbaugh, Associate Professor and Graduate Coordinator, School of Urban and Regional Planning, Florida Atlantic University; Robert Kamm, Executive Director, Space Coast Transportation Planning Agency

HAVANA: PARADIGM OF A CARIBBEAN CITY [New Urbanism in the New World]

Meeting Room 2 ABC

Transcending the speculative, religious, military, and formal intentions operating since the time of the conquistadores, Havana has evolved over five centuries as a harmonious, spatially identifiable city with a traditional, yet pragmatic urban plan; one that is accommodating to pedestrians and ingratiated by its public spaces and well-defined streets. At first glance, the present-day layout of the city of Havana could seem haphazard due to its patchwork design pattern of 'remnants', but upon further inspection the stitch-work of its organization becomes more evident. Its resulting composition can be attributed to the diverse leyes (laws) and ordenanzas (codes) that over time have both been informed by and, in turn, shaped the city's complex layout. Analysis illustrates the relevance of those inherited or home grown design concepts, and their adaptability to 21st century challenges and opportunities, which sustain physical, cultural, and spiritual traditions.

Moderator: Sonia Chao, Director, Center for Urban and Community Design
Eduardo Luis Rodriguez; Isabel Rigol

SPRAWL REPAIR AND INFILL: FROM INCREMENTAL TO WETROFIT TO AGRICULTURE [Open Innovation]

Meeting Room 1 J

From infrastructure to architecture to backyard gardening, explore a variety of sprawl repair and infill innovations. Topics include: growing food at all scales, incremental sprawl repair, the Sky Method applied to sprawl repair, a new kind of rental home, right-sized housing, and "Wetrofit" for green infrastructure.

Harriet Festing, Director, Center for Neighborhood Technology (CNT); Neil Heller, Urbanist, Community by Design LLC; Henry Melendy, Owner and President, My Yard Farm, LLC; Steve A. Mouzon, AIA, LEED, Principal, The New Urban Guild; Robert Sharp, Principal, Robert Sharp Architect, Inc., Partners for Better Housing Brian Teague, PE CNU, Director of Design, Community by Design; Tony Weremeichik, Principal, Architectural Design Studio; Greg Witherspoon, Vice President, Canin Associates

ACHIEVING SUSTAINABLE COMMUNITIES

[Sustainability and Livability]

Ballroom A

This session will focus on implementation of sustainable planning principles on a regional scale in South Florida, and on a citywide scale in El Paso, Texas. Both areas are getting substantial help through the federal government. The federal Sustainable Communities Initiative is playing a key role in transforming regional planning and how housing and transportation dollars are spent.

Moderator: Victor Dover, CNU-A, Principal, Dover, Kohl & Partners
Michael Busha, Executive Director, Treasure Coast Regional Planning Council; Mathew McElroy, AICP, CNU-A, Deputy Director, Planning & Economic Development, City of El Paso, TX; Shelley Poticha, Senior Adviser for Sustainable Housing and Communities, Department of Housing and Urban Development; Rob Steuteville, Editor/Publisher, Better! Cities & Towns

SATURDAY NIGHT CLOSING PLENARY: MEMO FOR THE NEXT DECADE

Sponsored by Bon Secours Virginia Health System

5:30 PM-6:30 PM

Grand Ballroom

Architect, urbanist and CNU founder Elizabeth Moule will offer a personal reflection on the last 20 years of the New Urbanism movement, and present her 'Memo for the Next Decade.' Physician and PBS personality Dr. Richard Jackson will discuss his latest findings on the links between the physical form of communities and the future health of their inhabitants.

*Victor Dover, CNU-A, Principal, Dover, Kohl & Partners
Richard Jackson, Professor and Chair, Environmental Health Sciences, University of California, Los Angeles School of Public Health
Elizabeth Moule, Principal, Moule & Polyzoides Architects & Urbanists
Ellen Dunham-Jones, Professor of Architecture and Urban Design, Georgia Institute of Technology*

CLOSING EVENT

7:30 PM-11:00 PM

Roxy's Pub, 309 N Clematis Street, West Palm Beach

Join the fun at the complimentary Saturday night closing party! Our farewell celebration will be at Roxy's Pub Rooftop, located at 309 Clematis Street, the historical heart of Downtown West Palm Beach. Enjoy a 360 degree view of West Palm Beach's urban core while you relax with your colleagues and celebrate the success of CNU 20! Your CNU badge gets you free admission to the rooftop. Hors d'oeuvres compliments of CNU Florida. Cash bar and dinner menu available.

SUNDAY MAY 13

GUIDED TOURS

All depart from and return to the convention center main entrance (Okeechobee Blvd). Require registration and a separate fee.

9:00 AM-5:00 PM / Windsor



WINDSOR

A PRIVATE RESIDENTIAL SPORTING CLUB
HOMES FROM \$1,250,000 TO \$6,000,000
WWW.WINDSORFLORIDA.COM

CNU 20 EXHIBIT FLOOR PLAN

PALM BEACH COUNTY CONVENTION CENTER

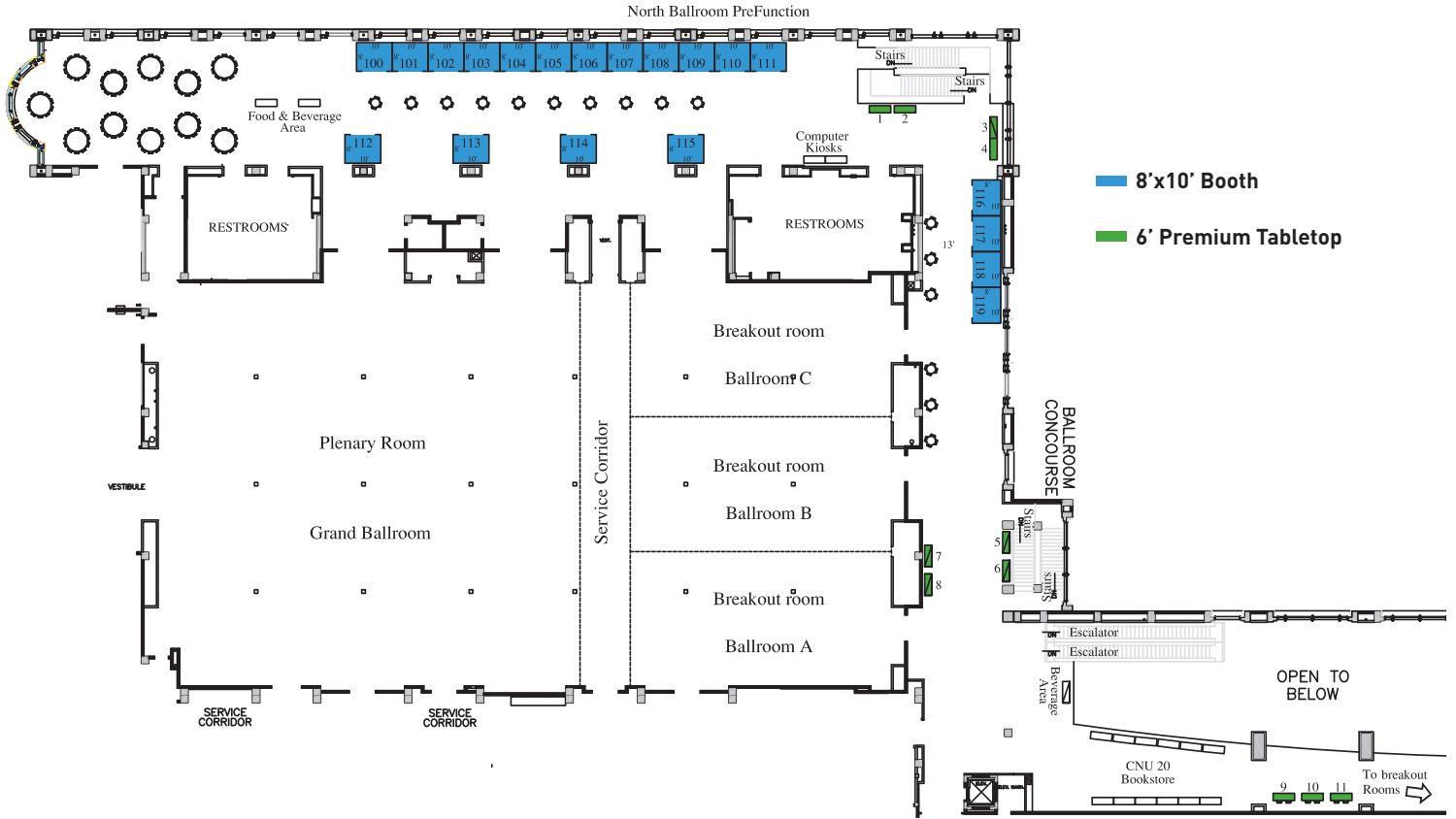

CNU 20 EXHIBITORS

ALLISON RAMSEY ARCHITECTS

Booths 106-107

Allison Ramsey Architects provides services from single family homes to town homes to town centers, design concepts to construction; from the scale of the building to the scale of the neighborhood. We provide development consultation, implementation, and planning services.
info@allisonramseyarchitect.com
www.allisonramseyarchitect.com

CANIN ASSOCIATES

Booth 111

CANIN ASSOCIATES is an interdisciplinary design firm of planners, landscape architects and architects. Canin Associates believes in designing great people places and this philosophy is integrated into all design concepts.
info@canin.com
www.canin.com

CARDNO ENTRIX/CARDNO TBE

Booth 108

Cardno ENTRIX is an environmental and natural resource management consulting firm specializing in water and natural resources management with 39 offices throughout North and South America.
terry.clark@cardno.com
richard.callahan@cardno.com
www.cardnoentrix.com

CDC NCEH/ATSDR

Table 9

Government: Environmental Public Health. CDC's National Center for Environmental Health and the Agency for Toxic Substances and Disease Registry scientifically considers all factors that affect the health of people, including healthy community design.

CITY ART GYM

Booth 101

City Art Gym offers a world unique Swedish design: A beautiful combination of public art and exercise equipment. The entire body can be trained on the three elegant sculptures.
info@cityartgym.com
www.cityartgym.com

CITY OF EL PASO - PLANNING DEPT.

Booth 113

El Paso, Texas: The Universe's Most New Urban Friendly City.
www.planelpaso.org

CITY OF MONTGOMERY DEPT. OF DEVELOPMENT

Table 1

Municipal services
chad.emerson@montgomeryal.gov
www.developmontgomery.com

CNU 21

Table 8

Visit the CNU 21 booth in anticipation of the 2013 congress in Salt Lake City, Utah, May 29 - June 1, 2013. Submit your program ideas, and get location information!
www.cnu21.org

CONGRESS FOR THE NEW URBANISM (CNU)

Table 7

The Congress for the New Urbanism (CNU) is a member-based, advocacy organization promoting walkable, mixed-use neighborhood development, sustainable communities and healthier living conditions. Not a CNU member? Join the movement for better performing cities and towns today at www.cnu.org/join.
info@cnu.org
www.cnu.org

GENX & ASSOCIATES

Booth 110

We work with communities to design sustainability current conditions research plans that empowers local leaders to have more intelligent planning implementation. It starts with data, and ends with a story.
info@genxandassociates.com
www.genxandassociates.com

GORMAN & COMPANY, INC.

Booth 109

At Gorman & Company, we work to revitalize communities through innovative housing partnerships. As a trusted partner and respected industry leader since 1984, we specialize in: downtown revitalization; the preservation of affordable housing, workforce housing, and the adaptive reuse of significant historic buildings.
info@gormanUSA.com
www.gormanUSA.com

ISLAND PRESS

Table 10

Island Press is a leading publisher of books about the built environment for professionals, students, and general readers. Check out our book signings!
info@islandpress.org
www.islandpress.org

LEWIS, LONGMAN & WALKER, P.A.

Booth 102

Legal Services: Environmental, Land Use, Natural Resources, Sustainability, Legislative & Governmental Affairs, Local Government & Special Districts and Water Resources
mdiffenderfer@llw-law.com
www.llw-law.com

LINCOLN INSTITUTE OF LAND POLICY

Booth 103

The Lincoln Institute of Land Policy is a leading resource for key issues concerning the use, regulation, and taxation of land. Providing high-quality education and research, the Institute strives to improve public dialogue and decisions about land policy.
anthony.flint@lincolninst.edu
www.lincolninst.edu

MINDMIXER

Table 5

MindMixer is a web-based idea generation and prioritization solution for city leaders, elected officials, stakeholder groups, and professional organizations.
info@mindmixer.com
www.mindmixer.com

NATIONAL CHARRETTE INSTITUTE AND FORM-BASED CODES INSTITUTE

Booth 105

Form-Based Codes and Charrettes are keys to obtaining good urbanism. Come see excerpts from the Driehaus Form-Based Codes Award winners and pick-up free materials about FBCs and Charrettes.
alan@formbasedcodes.org
heidid@charretteinstitute.org
www.formbasedcodes.org; charretteinstitute.org

ROLLINS COLLEGE MASTER OF PLANNING IN CIVIC URBANISM PROGRAM

Table 6

Rollins College's Master of Planning in Civic Urbanism provides classroom work, professional expertise, studio projects, and internships to prepare you for a career in either private practice or government.
rollins.edu/evening
www.rollins.edu/evening

SOUTH FLORIDA REGIONAL TRANSPORTATION AUTHORITY

Booth 114

South Florida's premier commuter rail service, promoting a responsible transportation system with transit-oriented, pedestrian-friendly connections. Less than a mile from Palm Beach Convention Center, your gateway to Broward and Miami-Dade.
garciav@sfrta.fl.gov
www.sfrta.fl.gov

THE GUILD FOUNDATION

Table 11

The mission of the New Urban Guild Foundation is to provide resources that allow people to build sustainable places and buildings that have an influence for good far beyond the boundaries of each project.
steve@newurbanguild.com
www.guildfoundation.org

TOWN PLANNING AND URBAN DESIGN COLLABORATIVE

Booth 115

TPUDC is a boutique New Urbanist town planning and urban design firm specializing in the design and implementation of walkable, mixed-use, pedestrian friendly places.
info@tpudc.com
www.tpudc.com

TUNNELL-SPANGLER-WALSH & ASSOCIATES

Booth 100

Planning, coding, architecture, landscape architecture
www.tsw-design.com

VINYL SIDING INSTITUTE

Booth 112

The Vinyl Siding Institute (VSI) is the trade association for manufacturers of vinyl and other polymeric siding and suppliers to the industry. The purpose of VSI is to further the development and growth of the vinyl siding industry.
vsi@vinylsiding.org
www.vinylsiding.org

PALM BEACH COUNTY CONVENTION CENTER MAP

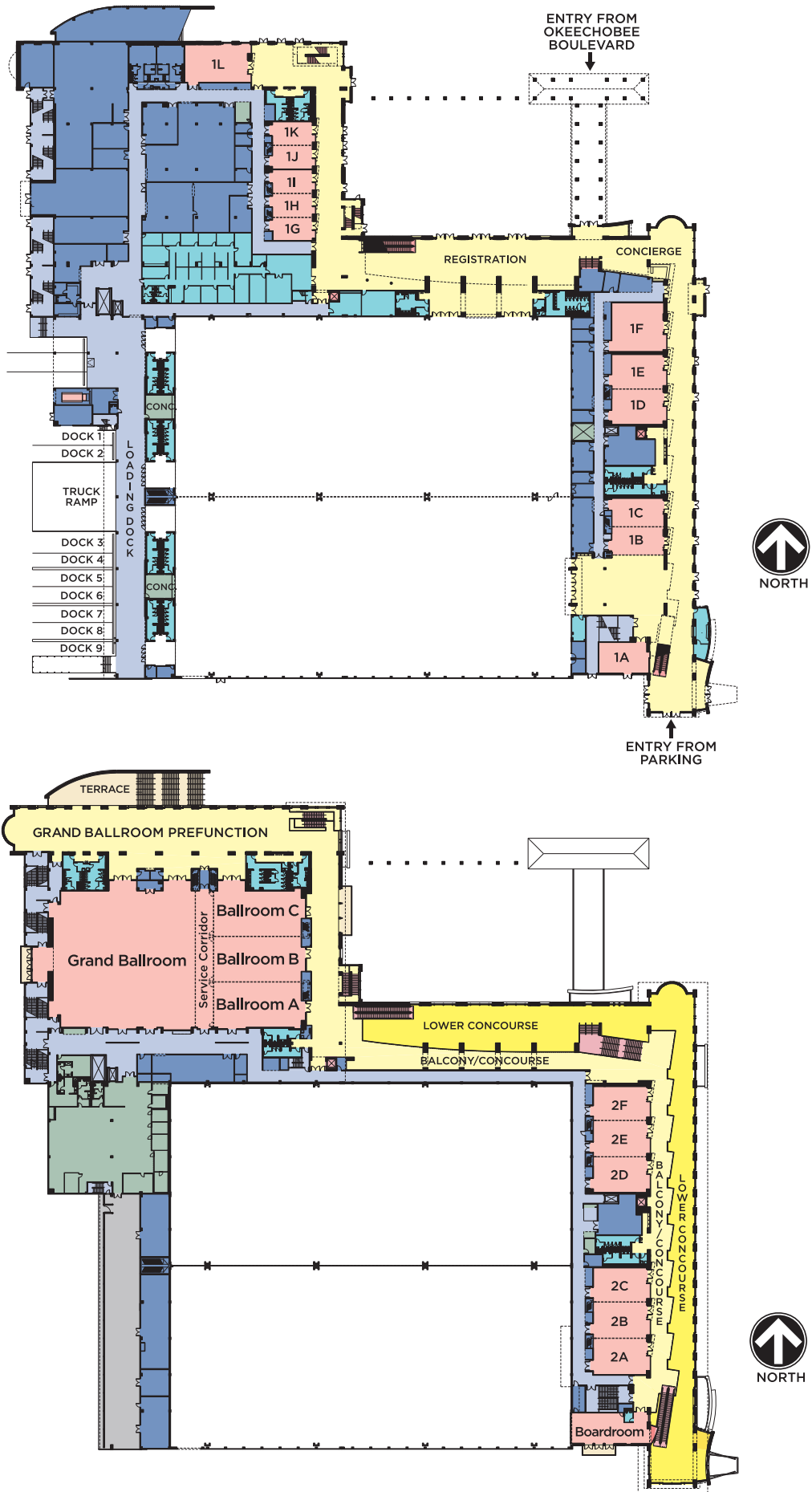

CNU 20 Executive Chairs & Committee Chairs

Natalie Bixby
Charles C. Bohl, Executive Chair
Michael Busha, Executive Chair
Marcela Cambor
Victor Dover, Executive Chair
Anthea Gianniotis
Rick Gonzalez
Eliza Harris
Debra Hempel
Dana Little
Elizabeth Plater-Zyberk, Executive Chair
Russell Preston, Executive Chair
Eloine Sabol
Stephanie Striefel

CNU 20 Local Host Committee

Ana Maria Aponte
Stephanie Bothwell
Marlene Brunot
Raphael Clemente
Jaime Correa
James Dougherty
Elizabeth Dowdle
Andrés Duany
Edward Erfurt
Andrew Georgiadis
Anthony Garcia
Norman Garrick
Erica Hall
Rick Hall
Mike Hathorne
Steven Head
Jennifer Hurley
Brenda Kelly
Jennifer Krouse
Matt Lambert
Jennifer Langford
Mike Lydon
Cheryl Mall
Charlotte Manley
Josh Martin
Scott Martin
Marcy McInelly
Maria Mercer
Commissioner Kimberly Mitchell
Friederike Mittner
The Honorable Mayor Jeri Muoio
James Moore
Christopher Rodriguez
Eloise Sahlstrom
Jean Scott
Daniel Slone
Rob Steuteville
Emily Talen
Todd Zimmerman

CNU 20 Board Advisors

Jack Davis
Norman Garrick
Jennifer Hurley
Elizabeth Plater-Zyberk
Russell Preston
Dhiru Thadani

CNU Board

Scott Bernstein
Jack Davis
Victor Dover (Chair)
Ellen Dunham-Jones (Vice Chair/Chair Elect)
Douglas Farr
Norman Garrick
Laura Heery
Jennifer Hurley (Treasurer)
Douglas Kelbaugh
Katharine Kelley
Mike Krusee
Sarah Lewis (Chapter Rep)
Steve Maun
Marcy McInelly
Connie Moran
Scott Polikov
Russ Preston (Secretary)
Sam Sherman
Dan Slone
Dhiru Thadani

Board Emeritus

Peter Calthorpe
Robert Davis
Andrés Duany
Elizabeth Moule
Elizabeth Plater-Zyberk
Stefanos Polyzoides
Daniel Solomon

CNU Staff

John O. Norquist, President and CEO
Abigail Bouzan-Kaloustian, Administration and Finance Director
Caitlin Ghoshal, Program Manager
Juantiki Jones, Membership Assistant
Mindy Martinez, Executive Assistant
Jeannette Mihalek, Development Director
Sandrine Milanello, Events Director
Benjamin Schulman, Communications Director
Heather Smith, Planning Director

CNU Corporate Members

BENEFACTORS

Dover Kohl & Partners
Nelson\Nygaard

CHAMPIONS

Gateway Planning Group
Green Street Properties
PlaceMakers, LLC
Urban Design Associates

LEADERS

Anonymous
GID Urban Development Group
Gragg & Associates
Lewis Longman & Walker, P.A.
LeylandAlliance LLC
Michigan State Housing Development Authority
Opticos Design, Inc.
PlusUrbia LLC
Space Between Design Studio
Steiner + Associates
Texas Tech University

Allied Organizations

American Society of Landscape Architects
American Society of Landscape Architects - Florida Chapter
Association of Pedestrian and Bicycle Professionals
Chicago Metropolitan Agency for Planning (CMAP)
Environmental Law & Policy Center
Local Government Commission
National Center for Bicycling & Walking
National Complete Streets Coalition
Reconnecting America
Rollins College Master of Planning in Civic Urbanism
USGBC South Florida Chapter
Volusia County Association for Responsible Development (VCARD)

CONGRESS
FOR THE
NEW
URBANISM

The Marquette Building
140 S. Dearborn Street
Suite 404
Chicago, IL 60603

WWW.CNU20.ORG

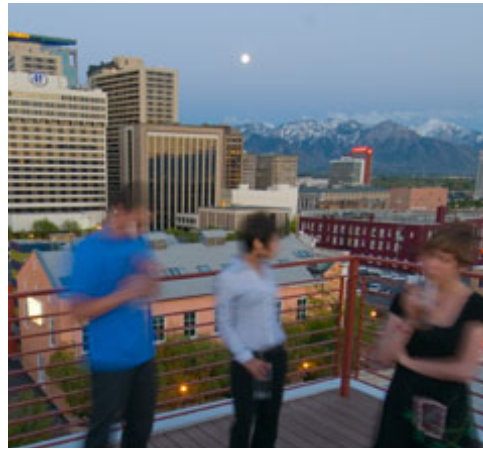

JOIN THE CONVERSATION, SHAPE
THE DESIGN OF OUR COMMUNITIES.

MAY 29-JUNE 1, 2013
SALT LAKE CITY, UT

CNU 21

LIVING
COMMUNITY
21st Annual Congress
for the New Urbanism